

INITIAL RECEIPT

United States Department of the Interior
Bureau of Land Management
 DIV OF LANDS, MINRLS & ENERGY
 ONE N CENTRAL AVE
 PHOENIX, AZ 85004 -4427
 Phone: 602-417-9200

Receipt	
No:	4726562

Transaction #: 4852019	
Date of Transaction: 04/20/2020	
CUSTOMER:	
BHP MINERAL RESOURCES INC 180 W MAGEE RD STE 134 TUCSON, AZ 85704-6495 US	

LINE #	QTY	DESCRIPTION	REMARKS	UNIT PRICE	TOTAL
1	18.00	LOCATABLE MINERALS / MINING CLAIMS- NEW, UNADJUD, ONE OR MORE AUTH NOS / NEW MINING CLAIM PROCESSING FEE CASES: AMC459820/\$20.00, AMC459821/\$20.00, AMC459822/\$20.00, AMC459823/\$20.00, AMC459824/\$20.00, AMC459825/\$20.00, AMC459826/\$20.00, AMC459827/\$20.00, AMC459828/\$20.00, AMC459829/\$20.00, AMC459830/\$20.00, AMC459831/\$20.00, AMC459832/\$20.00, AMC459833/\$20.00, AMC459834/\$20.00, AMC459835/\$20.00, AMC459836/\$20.00, AMC459837/\$20.00		- n/a -	360.00
2	18.00	LOCATABLE MINERALS / MINING CLAIMS- NEW, UNADJUD, ONE OR MORE AUTH NOS / NEW MINING CLAIMS LOCATION FEE CASES: AMC459820/\$40.00, AMC459821/\$40.00, AMC459822/\$40.00, AMC459823/\$40.00, AMC459824/\$40.00, AMC459825/\$40.00, AMC459826/\$40.00, AMC459827/\$40.00, AMC459828/\$40.00, AMC459829/\$40.00, AMC459830/\$40.00, AMC459831/\$40.00, AMC459832/\$40.00, AMC459833/\$40.00, AMC459834/\$40.00, AMC459835/\$40.00, AMC459836/\$40.00, AMC459837/\$40.00		- n/a -	720.00
3	18.00	LOCATABLE MINERALS / MINING CLAIMS- NEW, UNADJUD, ONE OR MORE AUTH NOS / NEW MINING CLAIMS MAINTENANCE FEE CASES: AMC459820/\$165.00, AMC459821/ \$165.00, AMC459822/\$165.00, AMC459823/ \$165.00		- n/a -	2970.00

ENTERED
 APR 29 2020
 BY: RAM

	\$165.00, AMC459824/\$165.00, AMC459825/ \$165.00, AMC459826/\$165.00, AMC459827/ \$165.00, AMC459828/\$165.00, AMC459829/ \$165.00, AMC459830/\$165.00, AMC459831/ \$165.00, AMC459832/\$165.00, AMC459833/ \$165.00, AMC459834/\$165.00, AMC459835/ \$165.00, AMC459836/\$165.00, AMC459837/\$165.00		
TOTAL:			\$4,050.00

PAYMENT INFORMATION			
1	AMOUNT:	4050.00	POSTMARKED: N/A
	TYPE:	CHECK	RECEIVED: 04/17/2020
	CHECK NO:	100300	
	NAME:	BHP MINERAL RESOURCES INC 180 W MAGEE RD STE 134 TUCSON AZ 85704-6495 US	

REMARKS

This receipt was generated by the automated BLM Collections and Billing System and is a paper representation of a portion of the official electronic record contained therein.

APR 17 2020

CORRESPONDENCE

TRANSFERS

MAINTENANCE FEES

WAIVERS

POL/NOI

MISCELLANEOUS

Tenement	Renewal
Hook 7	\$ 225.00
Hook 8	\$ 225.00
Hook 18	\$ 225.00
Hook 19	\$ 225.00
Hook 29	\$ 225.00
Hook 30	\$ 225.00
Hook 40	\$ 225.00
Hook 41	\$ 225.00
Hook 51	\$ 225.00
Hook 52	\$ 225.00
Hook 62	\$ 225.00
Hook 63	\$ 225.00
Hook 73	\$ 225.00
Hook 74	\$ 225.00
Hook 85	\$ 225.00
Hook 86	\$ 225.00
Hook 96	\$ 225.00
Hook 97	\$ 225.00

PHOENIX, ARIZONA

2020 APR 17 A 8:54

RECEIVED
ELM A 7 STATE OFFICE

**LOCATION NOTICES
AMENDMENTS
STATUS SHEET
GEO REPORT/MTP**

MINING CLAIM STATUS REPORT – Assessment Year 2020

Data Entered: 4/29/2020

MTP Checked By: 4/29/2020
 GEO Checked By: 4/29/2020

LEAD SERIAL NUMBER: AMC 459820 thru AMC 459837

NUMBER OF CLAIMS & TYPE:
18 LODE
 _____ PLACER
 _____ ASSOCIATION PLACER
 _____ MILL SITE
 _____ TUNNEL SITE

CHARGES:
 Processing Fee @ \$20 = \$ 360
 Location Fee @ \$40 = \$ 720
 Maintenance Fee @ \$165 = \$ 2,970
 Add'l Maint Fee for Assoc Placer = \$ _____
SUBTOTAL \$ _____
 Other Fees \$ _____
 Other Fees \$ _____
TOTAL \$ 4,050

TOTAL ACREAGE: _____ Per Claim
 (Placer Only)

NUMBER OF LOCATORS: _____

DOCUMENTS RECEIVED VIA: Over-the-Counter [] Mail **TIMELY FILED:** Yes No []

LEGAL DESCRIPTION: T 2N R 15.5E SEC 34, 35
 T 1N R 15.5E SEC 2, 3
 T _____ R _____ SEC _____
 T _____ R _____ SEC _____
 T _____ R _____ SEC _____

BLM [] FOREST SERVICE [] _____ SUBJ TO PL 359: Yes [] No []
 WILDERNESS AREA [] _____

SPLIT ESTATE: N/A [] SX [] PX [] OTHER [] _____
 SRHA [] Was proper Notice filed if located on SHRA Land? Yes [] No []

RECONVEYED MINERALS ON BLM LAND REQUIRE OPENING ORDER FROM 1944 TO 1993:
 Open to Entry On _____ N/A []

COMMENTS/STATUS: VOID [] PARTIALLY VOID [] PVT MINERALS [] WITHDRAWN LANDS []
 OTHER [] _____

[] Claimant acknowledges that portions of the following claim(s) site(s) may be void or voidable.

Printed Name of Claimant _____ Signature of Claimant _____

*****FINAL ADJUDICATION*****

DATE _____ INITIALS _____

AHC459820

When recorded return to:

Attn: Jon Bryant-Baker
BHP Mineral Resources Inc.
180 Magee Suite 134
Tucson, Arizona 85704

LOCATION NOTICE FOR LODE MINING CLAIM

NOTICE IS HEREBY GIVEN that the HOOK 7
_____ lode mining claim has been located
by BHP Mineral Resources Inc. whose current mailing
address is 180 Magee Suite 134
Tucson, AZ 85704

RECEIVED
BLM AZ STATE OFFICE
2020 APR 17 A 8:54
PHOENIX, ARIZONA

The general course of this claim is East/West and it is situated in Gila
County, Arizona. This claim is 1500 feet in length and 600 feet in width. This claim runs
from the location monument on which this location notice is posted approximately 1490 feet in a
easterly direction to the east end line and 10 feet in a westerly direction to the
west end line. This claim is marked by six monuments, one at each corner and one at the center of each
end line of the claim.

The location monument on which this notice is posted is situated within Section 35, Township 2
North, Range 15.5 East, Gila Salt River Base and Meridian, Arizona and this claim encompasses portions
of the following quarter section (s), section (s), Township (s) and Range (s) NW 1/4 of the NW 1/4 and NE
1/4 of the NW 1/4 of Section 35, Township 2 North, Range 15.5 East, Gila & Salt River Base and Meridian,
Gila County, Arizona, Globe Mining District.

The locality of this claim with reference to some natural object or permanent monument and additional information
(if any) concerning its locality are as follows: 21386 feet north and 17392 feet east from the southwest corner of
Section 14, Township 1 North, Range 15 East, to the northeast corner of said claim.

DATED AND POSTED on the ground this 26th day of February, 2020

LOCATOR (s) BHP Mineral Resources Inc.
180 Magee Suite 134
Tucson, AZ 85704

AGENT: T. Robert Breen / 

AMC459820

LODE CLAIM LOCATION MAP

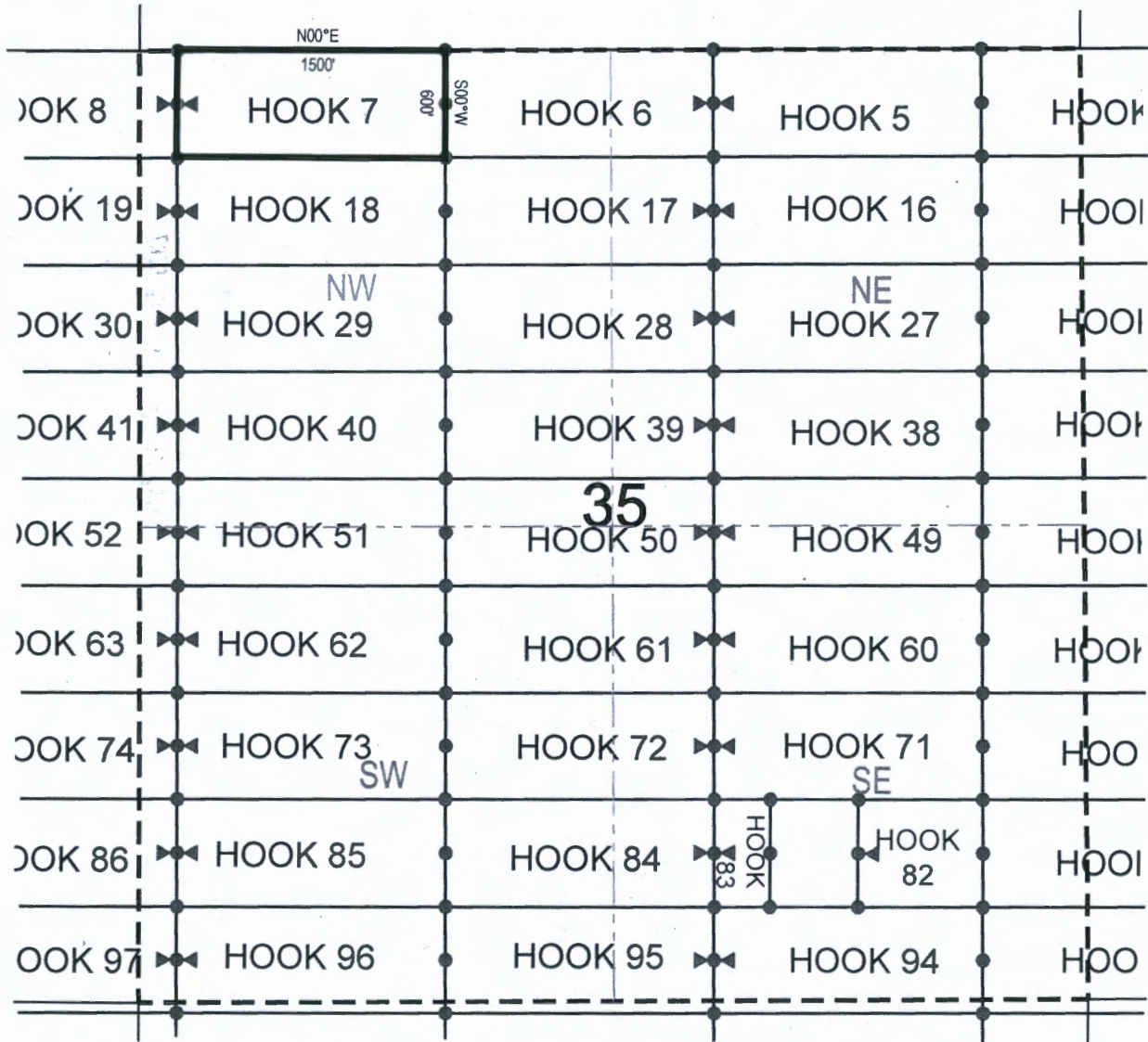

● Corner Posts ▲ Location Monuments Scale: 1"=1000'



1. The above map depicts the HOOK 7 Lode Claim, which is located in the NW 1/4 of the NW 1/4 and NE 1/4 of the NW 1/4 of Section 35, Township 2 North, Range 15.5 East, Gila & Salt River Base and Meridian, Gila County, Arizona, Globe Mining District.
2. The type of corner and location monuments used are wood 2"x2"x48" posts and metal tags with location information written thereon.
3. The bearings and distances in degrees and feet between claim corners are as depicted on the above map.

When recorded return to:
Attn: Jon Bryant-Baker
BHP Mineral Resources Inc.
180 Magee Suite 134
Tucson, Arizona 85704

LOCATION NOTICE FOR LODE MINING CLAIM

NOTICE IS HEREBY GIVEN that the HOOK 8
_____ lode mining claim has been located
by BHP Mineral Resources Inc. whose current mailing
address is 180 Magee Suite 134
Tucson, Arizona 85704

RECEIVED
BLM AZ STATE OFFICE
2020 APR 17 A 8:54
PHOENIX, ARIZONA

The general course of this claim is East/West and it is situated in Gila
County, Arizona. This claim is 1500 feet in length and 600 feet in width. This claim runs
from the location monument on which this location notice is posted approximately 10 feet in a
easterly direction to the east end line and 1490 feet in a westerly direction to the
west end line. This claim is marked by six monuments, one at each corner and one at the center of each
end line of the claim.

The location monument on which this notice is posted is situated within Section 35, Township 2
North, Range 15.5 East, Gila Salt River Base and Meridian, Arizona and this claim encompasses portions
of the following quarter section (s), section (s), Township (s) and Range (s) NW 1/4 of the NW 1/4 of Section
35, and NE 1/4 of the NE 1/4 of Section 34, Township 2 North, Range 15.5 East, Gila & Salt River Base and
Meridian, Gila County, Arizona, Globe Mining District.

The locality of this claim with reference to some natural object or permanent monument and additional information
(if any) concerning its locality are as follows: 21377 feet north and 15892 feet east from the southwest corner of
Section 14, Township 1 North, Range 15 East, to the northeast corner of said claim.

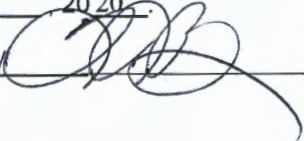
DATED AND POSTED on the ground this 26th day of February 2020
LOCATOR (s) BHP Mineral Resources Inc. AGENT: T. Robert Breen / 
180 Magee Suite 134
Tucson, Arizona 85704

AMC459821

LODE CLAIM LOCATION MAP

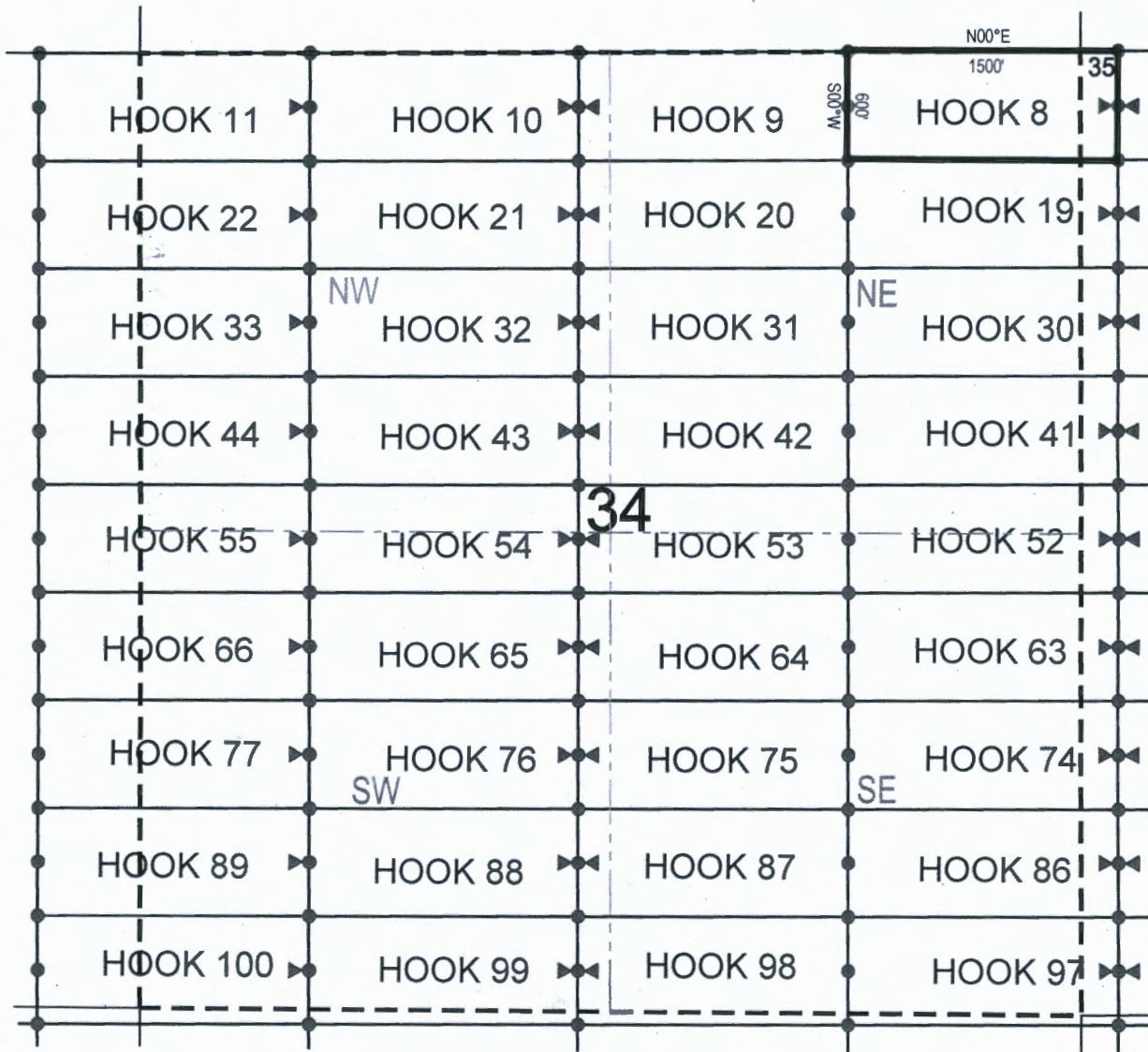

● Corner Posts ▲ Location Monuments Scale: 1"=1000'



1. The above map depicts the **HOOK 8** Lode Claim, which is located in the NW 1/4 of the NW 1/4 of Section 35, and NE 1/4 of the NE 1/4 of Section 34, Township 2 North, Range 15.5 East, Gila & Salt River Base and Meridian, Gila County, Arizona, Globe Mining District.
2. The type of corner and location monuments used are wood 2"x2"x48" posts and metal tags with location information written thereon.
3. The bearings and distances in degrees and feet between claim corners are as depicted on the above map.

LODE CLAIM LOCATION MAP

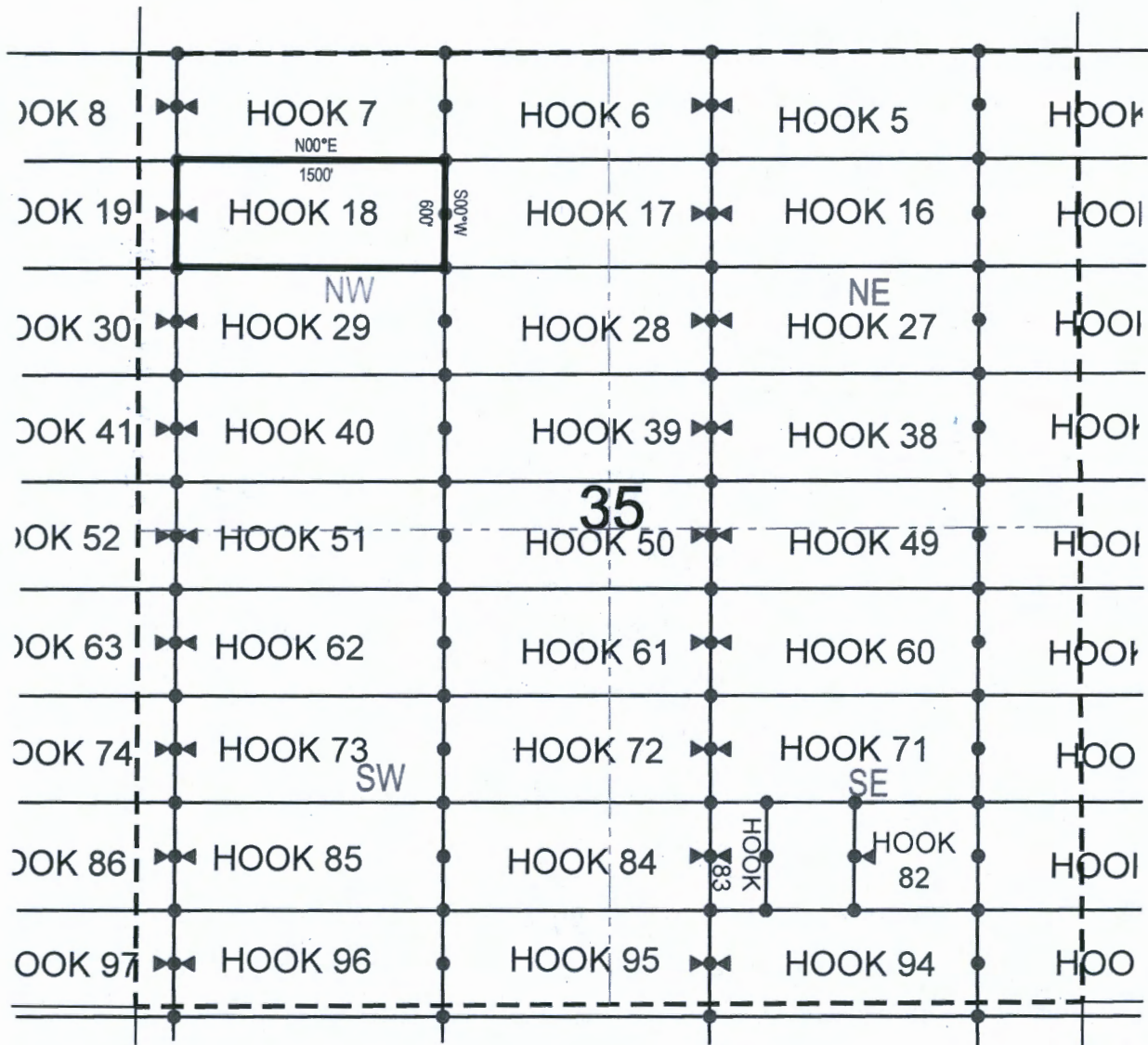

● Corner Posts ▲ Location Monuments Scale: 1"=1000'



1. The above map depicts the **HOOK 18** Lode Claim, which is located in the NW 1/4 of the NW 1/4 and NE 1/4 of the NW 1/4 of Section 35, Township 2 North, Range 15.5 East, Gila & Salt River Base and Meridian, Gila County, Arizona, Globe Mining District.
2. The type of corner and location monuments used are wood 2"x2"x48" posts and metal tags with location information written thereon.
3. The bearings and distances in degrees and feet between claim corners are as depicted on the above map.

When recorded return to:

Attn: Jon Bryant-Baker
BHP Mineral Resources Inc.
180 Magee Suite 134
Tucson, Arizona 85704

LOCATION NOTICE FOR LODE MINING CLAIM

NOTICE IS HEREBY GIVEN that the HOOK 19
_____ lode mining claim has been located
by BHP Mineral Resources Inc. whose current mailing
address is 180 Magee Suite 134
Tucson, Arizona 85704

RECEIVED
PLM & ZONING OFFICE
2020 APR 17 A 8:54
PHOENIX, ARIZONA

The general course of this claim is East/West and it is situated in Gila
County, Arizona. This claim is 1500 feet in length and 600 feet in width. This claim runs
from the location monument on which this location notice is posted approximately 10 feet in a
easterly direction to the east end line and 1490 feet in a westerly direction to the
west end line. This claim is marked by six monuments, one at each corner and one at the center of each
end line of the claim.

The location monument on which this notice is posted is situated within Section 35, Township 2
North, Range 15.5 East, Gila Salt River Base and Meridian, Arizona and this claim encompasses portions
of the following quarter section (s), section (s), Township (s) and Range (s) NW 1/4 of the NW 1/4 of Section
35, and NE 1/4 of the NE 1/4 of Section 34, Township 2 North, Range 15.5 East, Gila & Salt River Base and
Meridian, Gila County, Arizona, Globe Mining District.

The locality of this claim with reference to some natural object or permanent monument and additional information
(if any) concerning its locality are as follows: 20777 feet north and 15895 feet east from the southwest corner of
Section 14, Township 1 North, Range 15 East, to the northeast corner of said claim.

DATED AND POSTED on the ground this 26th day of February, 2020

LOCATOR (s) BHP Mineral Resources Inc. AGENT: T. Robert Breen / 
180 Magee Suite 134
Tucson, Arizona 85704

ANCI459823

LODE CLAIM LOCATION MAP

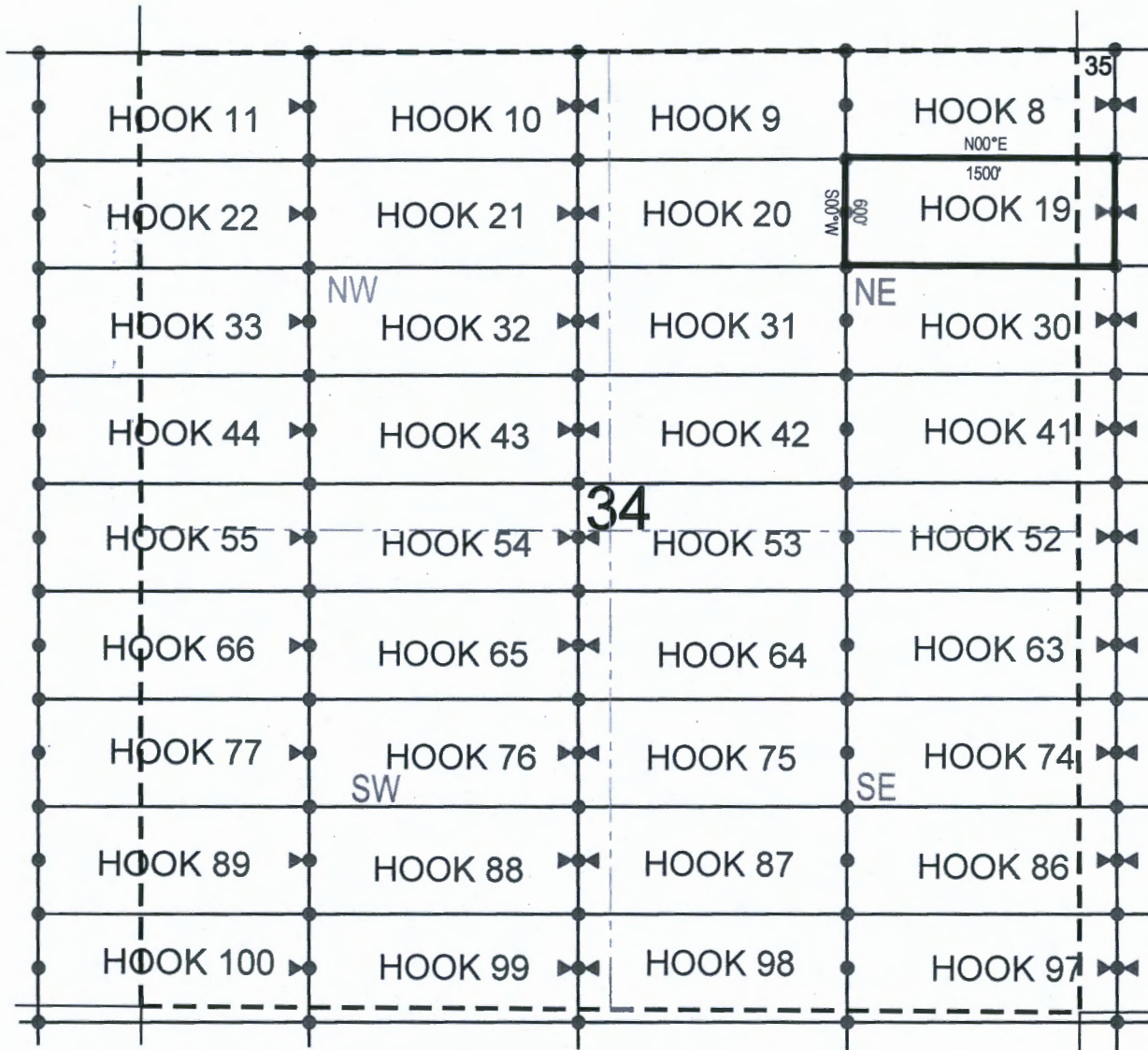

● Corner Posts ▲ Location Monuments Scale: 1"=1000'



1. The above map depicts the **HOOK 19** Lode Claim, which is located in the NW 1/4 of the NW 1/4 of Section 35, and NE 1/4 of the NE 1/4 of Section 34, Township 2 North, Range 15.5 East, Gila & Salt River Base and Meridian, Gila County, Arizona, Globe Mining District.
2. The type of corner and location monuments used are wood 2"x2"x48" posts and metal tags with location information written thereon.
3. The bearings and distances in degrees and feet between claim corners are as depicted on the above map.

When recorded return to:

Attn: Jon Bryant-Baker
BHP Mineral Resources Inc.
180 Magee Suite 134
Tucson, Arizona 85704

LOCATION NOTICE FOR LODE MINING CLAIM

NOTICE IS HEREBY GIVEN that the HOOK 29
_____ lode mining claim has been located
by BHP Mineral Resources Inc whose current mailing
address is 180 Magee Suite 134
Tucson, Arizona 85704

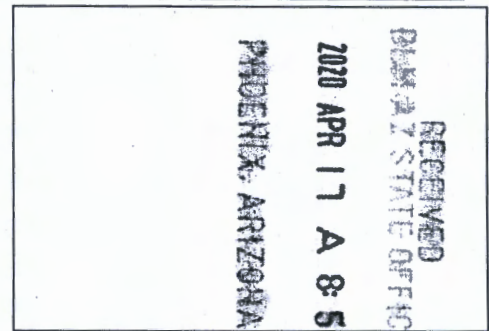

The general course of this claim is East/West and it is situated in Gila
County, Arizona. This claim is 1500 feet in length and 600 feet in width. This claim runs
from the location monument on which this location notice is posted approximately 1490 feet in a
easterly direction to the east end line and 10 feet in a westerly direction to the
west end line. This claim is marked by six monuments, one at each corner and one at the center of each
end line of the claim.

The location monument on which this notice is posted is situated within Section 35, Township 2
North, Range 15.5 East, Gila Salt River Base and Meridian, Arizona and this claim encompasses portions
of the following quarter section (s), section (s), Township (s) and Range (s) SW 1/4 of the NW 1/4, SE 1/4 of
the NW 1/4, NE 1/4 of the NW 1/4 and NW 1/4 of the NW 1/4 of Section 35, Township 2 North, Range 15.5
East, Gila & Salt River Base and Meridian, Gila County, Arizona, Globe Mining District.

The locality of this claim with reference to some natural object or permanent monument and additional information
(if any) concerning its locality are as follows: 20186 feet north and 17399 feet east from the southwest corner of
Section 14, Township 1 North, Range 15 East, to the northeast corner of said claim.

DATED AND POSTED on the ground this 26th day of February, 2020

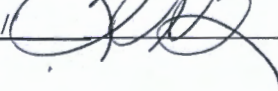
LOCATOR (s) BHP Mineral Resources Inc. AGENT: T. Robert Breen / 
180 Magee Suite 134
Tucson, Arizona 85704

AMC459824

When recorded return to:
Attn: Jon Bryant-Baker
BHP Mineral Resources Inc.
180 Magee Suite 134
Tucson, Arizona 85704

LOCATION NOTICE FOR LODE MINING CLAIM

NOTICE IS HEREBY GIVEN that the HOOK 30
_____ lode mining claim has been located
by BHP Mineral Resources Inc. whose current mailing
address is 180 Magee Suite 134
Tucson, Arizona 85704

RECEIVED
BLM AZ STATE OFFICE
2020 APR 17 A 8:54
PHOENIX, ARIZONA

The general course of this claim is East/West and it is situated in Gila
County, Arizona. This claim is 1500 feet in length and 600 feet in width. This claim runs
from the location monument on which this location notice is posted approximately 10 feet in a
easterly direction to the east end line and 1490 feet in a westerly direction to the
west end line. This claim is marked by six monuments, one at each corner and one at the center of each
end line of the claim.

The location monument on which this notice is posted is situated within Section 35, Township 2
North, Range 15.5 East, Gila Salt River Base and Meridian, Arizona and this claim encompasses portions
of the following quarter section (s), section (s), Township (s) and Range (s) SW 1/4 of the NW 1/4 and NW 1/4
of the NW 1/4 of Section 35, and NE 1/4 of the NE 1/4 and SE 1/4 of the NE 1/4 of Section 34, Township 2
North, Range 15.5 East, Gila & Salt River Base and Meridian, Gila County, Arizona, Globe Mining District.

The locality of this claim with reference to some natural object or permanent monument and additional information
(if any) concerning its locality are as follows: 20177 feet north and 15899 feet east from the southwest corner of
Section 14, Township 1 North, Range 15 East, to the northeast corner of said claim.

DATED AND POSTED on the ground this 26th day of February, 2020
LOCATOR (s) BHP Mineral Resources Inc. AGENT: T. Robert Breen
180 Magee Suite 134
Tucson, Arizona 85704

ANC459825

LODE CLAIM LOCATION MAP

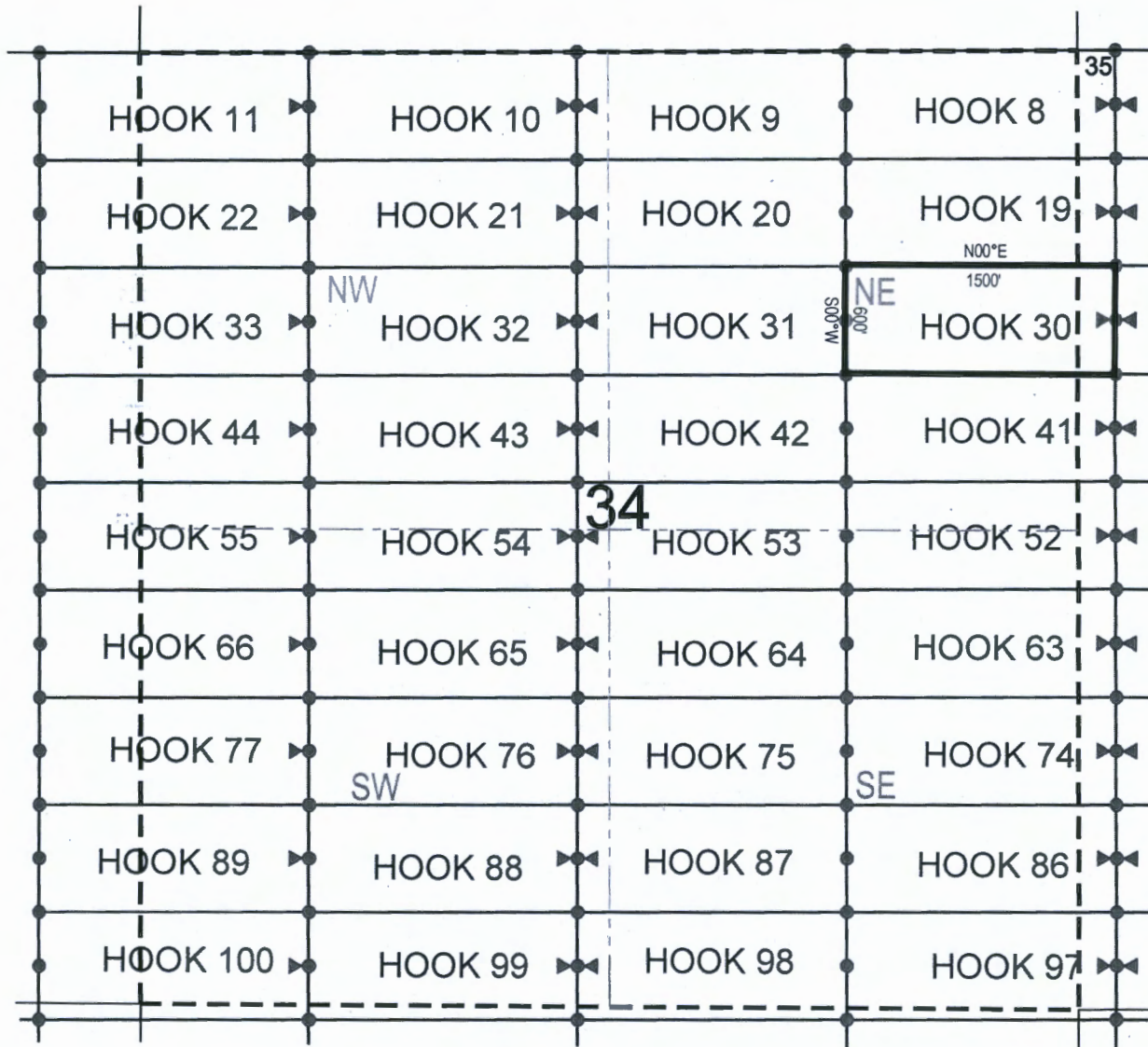

● Corner Posts ▲ Location Monuments Scale: 1"=1000'



1. The above map depicts the **HOOK 30** Lode Claim, which is located in the SW 1/4 of the NW 1/4 and NW 1/4 of the NW 1/4 of Section 35, and NE 1/4 of the NE 1/4 and SE 1/4 of the NE 1/4 of Section 34, Township 2 North, Range 15.5 East, Gila & Salt River Base and Meridian, Gila County, Arizona, Globe Mining District.
2. The type of corner and location monuments used are wood 2"x2"x48" posts and metal tags with location information written thereon.
3. The bearings and distances in degrees and feet between claim corners are as depicted on the above map.

When recorded return to:

Attn: Jon Bryant-Baker
BHP Mineral Resources Inc.
180 Magee Suite 134
Tucson, Arizona 85704

LOCATION NOTICE FOR LODE MINING CLAIM

NOTICE IS HEREBY GIVEN that the HOOK 40
_____ lode mining claim has been located
by BHP Mineral Resources Inc. whose current mailing
address is 180 Magee Suite 134
Tucson, Arizona 85704

RECEIVED
DEPT. OF STATE OFFICE
2020 APR 17 A 8:54
PHOENIX, ARIZONA

The general course of this claim is East/West and it is situated in Gila
County, Arizona. This claim is 1500 feet in length and 600 feet in width. This claim runs
from the location monument on which this location notice is posted approximately 1490 feet in a
easterly direction to the east end line and 10 feet in a westerly direction to the
west end line. This claim is marked by six monuments, one at each corner and one at the center of each
end line of the claim.

The location monument on which this notice is posted is situated within Section 35, Township 2
North, Range 15.5 East, Gila Salt River Base and Meridian, Arizona and this claim encompasses portions
of the following quarter section (s), section (s), Township (s) and Range (s) SW 1/4 of the NW 1/4 and SE 1/4
of the NW 1/4 of Section 35, Township 2 North, Range 15.5 East, Gila & Salt River Base and Meridian, Gila
County, Arizona, Globe Mining District.

The locality of this claim with reference to some natural object or permanent monument and additional information
(if any) concerning its locality are as follows: 19586 feet north and 17402 feet east from the southwest corner of
Section 14, Township 1 North, Range 15 East, to the northeast corner of said claim.

DATED AND POSTED on the ground this 26th day of February, 2020

LOCATOR (s) BHP Mineral Resources Inc. AGENT: T. Robert Breen/
180 Magee Suite 134
Tucson, Arizona 85704

AMC 459826

LODE CLAIM LOCATION MAP

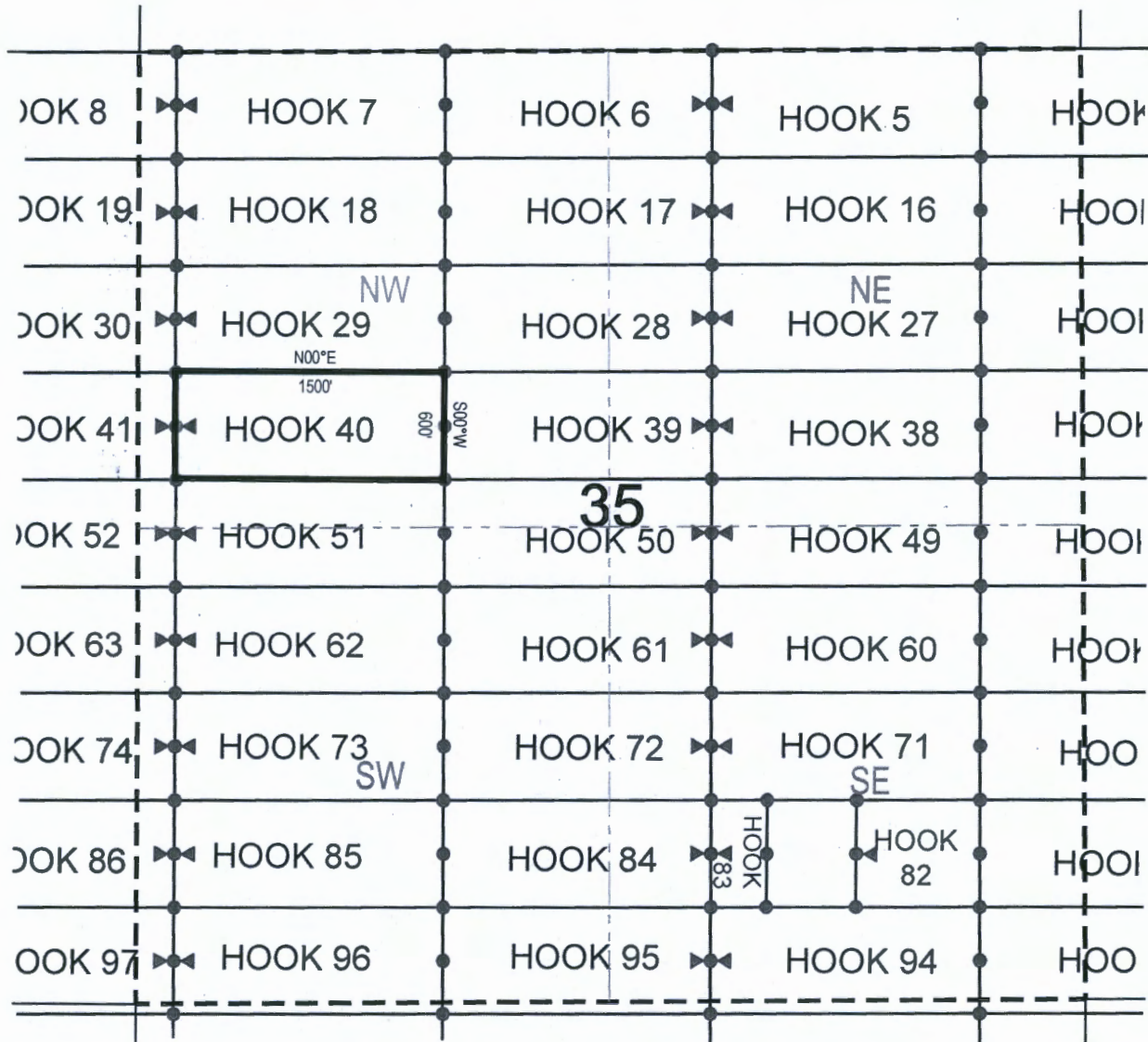

● Corner Posts ▲ Location Monuments Scale: 1"=1000'



1. The above map depicts the **HOOK 40** Lode Claim, which is located in the SW 1/4 of the NW 1/4 and SE 1/4 of the NW 1/4 of Section 35, Township 2 North, Range 15.5 East, Gila & Salt River Base and Meridian, Gila County, Arizona, Globe Mining District.
2. The type of corner and location monuments used are wood 2"x2"x48" posts and metal tags with location information written thereon.
3. The bearings and distances in degrees and feet between claim corners are as depicted on the above map.

When recorded return to:

Attn: Jon Bryant-Baker
BHP Mineral Resources Inc.
180 Magee Suite 134
Tucson, Arizona 85704

LOCATION NOTICE FOR LODE MINING CLAIM

NOTICE IS HEREBY GIVEN that the HOOK 41
_____ lode mining claim has been located
by BHP Mineral Resources Inc. whose current mailing
address is 180 Magee Suite 13
Tucson, Arizona 85704

RECEIVED
BLM AZ STATE OFFICE
2020 APR 17 A 8:54
PHOENIX, ARIZONA

The general course of this claim is East/West and it is situated in Gila
County, Arizona. This claim is 1500 feet in length and 600 feet in width. This claim runs
from the location monument on which this location notice is posted approximately 10 feet in a
easterly direction to the east end line and 1490 feet in a westerly direction to the
west end line. This claim is marked by six monuments, one at each corner and one at the center of each
end line of the claim.

The location monument on which this notice is posted is situated within Section 35, Township 2
North, Range 15.5 East, Gila Salt River Base and Meridian, Arizona and this claim encompasses portions
of the following quarter section (s), section (s), Township (s) and Range (s) SW 1/4 of the NW 1/4 of Section
35, and SE 1/4 of the NE 1/4 of Section 34, Township 2 North, Range 15.5 East, Gila & Salt River Base and
Meridian, Gila County, Arizona, Globe Mining District.

The locality of this claim with reference to some natural object or permanent monument and additional information
(if any) concerning its locality are as follows: 19577 feet north and 15902 feet east from the southwest corner of
Section 14, Township 1 North, Range 15 East, to the northeast corner of said claim.

DATED AND POSTED on the ground this 26h day of February, 2020

LOCATOR (s) BHP Mineral Resources Inc. AGENT: T. Robert Breen / 
180 Magee Suite 134
Tucson, Arizona 85704

AMC459827

LODE CLAIM LOCATION MAP

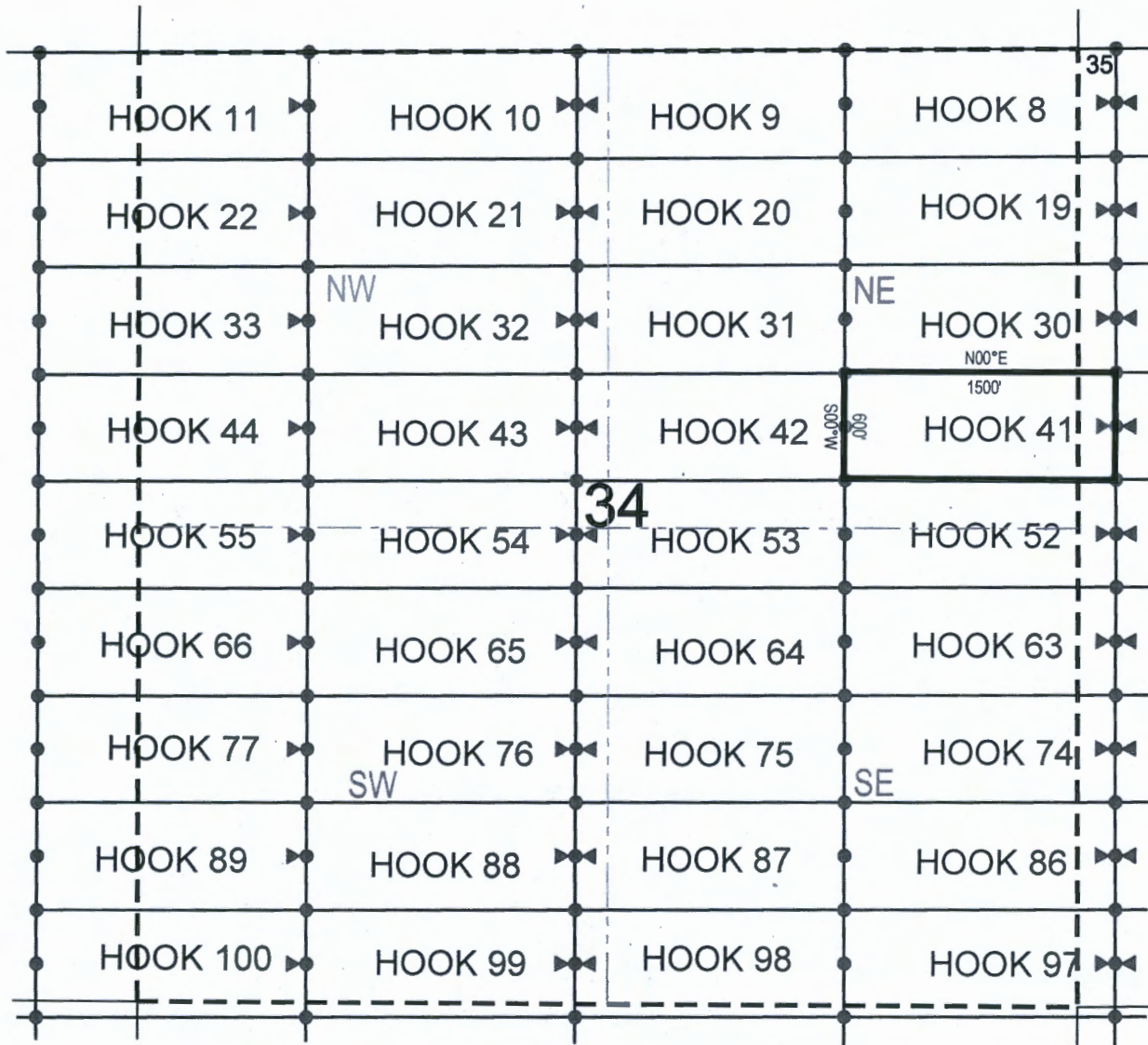

● Corner Posts ▲ Location Monuments Scale: 1"=1000'



1. The above map depicts the **HOOK 41** Lode Claim, which is located in the SW 1/4 of the NW 1/4 of Section 35, and SE 1/4 of the NE 1/4 of Section 34, Township 2 North, Range 15.5 East, Gila & Salt River Base and Meridian, Gila County, Arizona, Globe Mining District.
2. The type of corner and location monuments used are wood 2"x2"x48" posts and metal tags with location information written thereon.
3. The bearings and distances in degrees and feet between claim corners are as depicted on the above map.

When recorded return to:

Attn: Jon Bryant-Baker
BHP Mineral Resources Inc.
180 Magee Suite 134
Tucson, Arizona 85704

LOCATION NOTICE FOR LODE MINING CLAIM

NOTICE IS HEREBY GIVEN that the HOOK 51
_____ lode mining claim has been located
by BHP Mineral Resources Inc. whose current mailing
address is 180 Magee Suite 134
Tucson, Arizona 85704

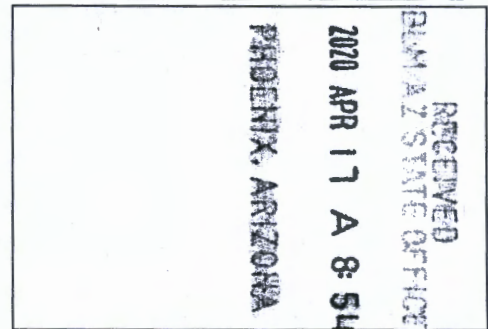

The general course of this claim is East/West and it is situated in Gila
County, Arizona. This claim is 1500 feet in length and 600 feet in width. This claim runs
from the location monument on which this location notice is posted approximately 1490 feet in a
easterly direction to the east end line and 10 feet in a westerly direction to the
west end line. This claim is marked by six monuments, one at each corner and one at the center of each
end line of the claim.

The location monument on which this notice is posted is situated within Section 35, Township 2
North, Range 15.5 East, Gila Salt River Base and Meridian, Arizona and this claim encompasses portions
of the following quarter section (s), section (s), Township (s) and Range (s) NW 1/4 of the SW 1/4 and NE 1/4
of the SW 1/4, and SE 1/4 of the NW 1/4 and SW 1/4 of the NW 1/4 of Section 35, Township 2 North, Range
15.5 East, Gila & Salt River Base and Meridian, Gila County, Arizona, Globe Mining District.

The locality of this claim with reference to some natural object or permanent monument and additional information
(if any) concerning its locality are as follows: 18986 feet north and 17406 feet east from the southwest corner of
Section 14, Township 1 North, Range 15 East, to the northeast corner of said claim.

DATED AND POSTED on the ground this 26th day of February, 2020.

LOCATOR (s) BHP Mineral Resources Inc. AGENT: T. Robert Breen 
180 Magee Suite 134
Tucson, Arizona 85704

AMC459828

LODE CLAIM LOCATION MAP

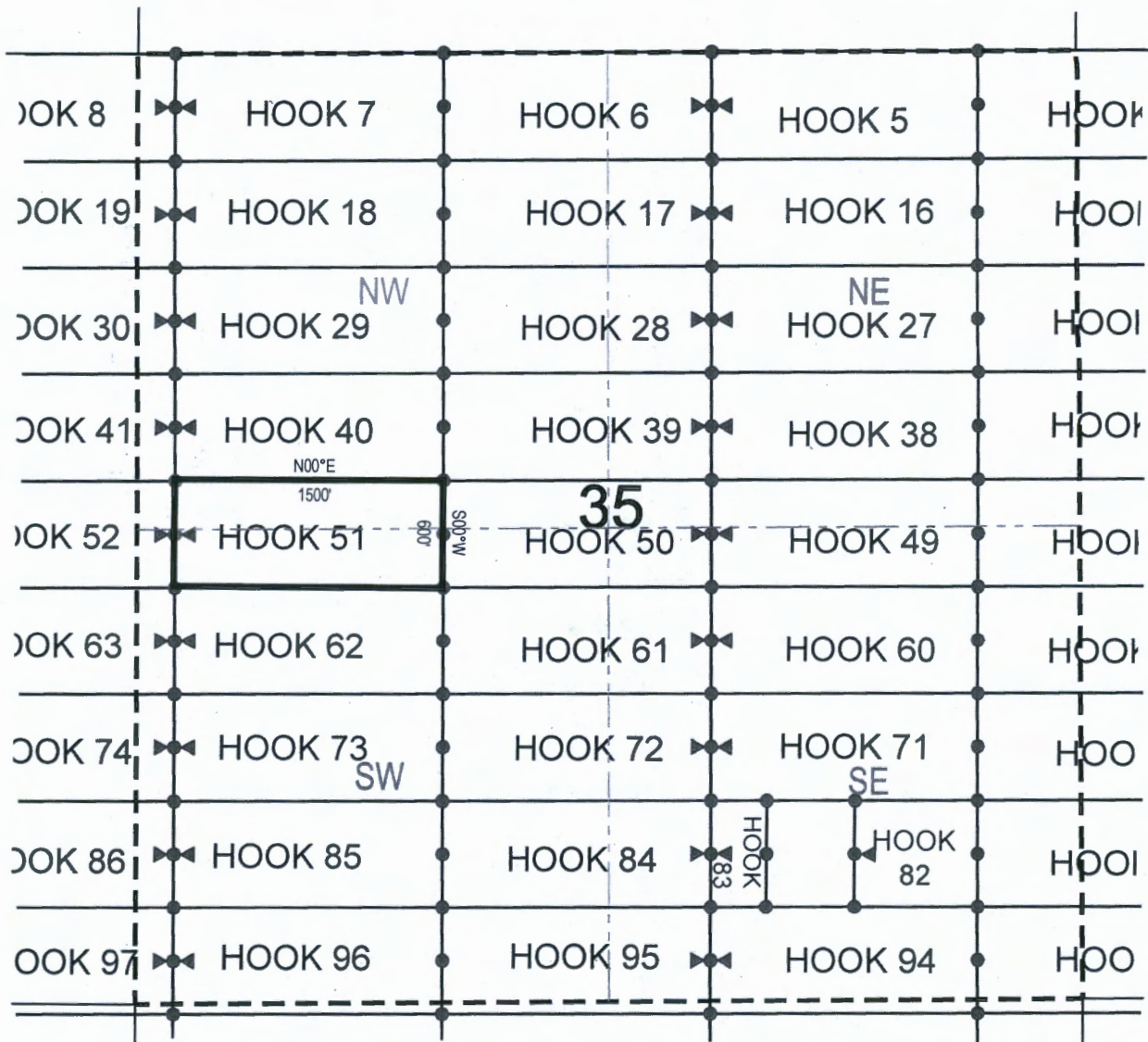

● Corner Posts ▲ Location Monuments Scale: 1"=1000'



1. The above map depicts the **HOOK 51** Lode Claim, which is located in the NW 1/4 of the SW 1/4 and NE 1/4 of the SW 1/4, and SE 1/4 of the NW 1/4 and SW 1/4 of the NW 1/4 of Section 35, Township 2 North, Range 15.5 East, Gila & Salt River Base and Meridian, Gila County, Arizona, Globe Mining District.
2. The type of corner and location monuments used are wood 2"x2"x48" posts and metal tags with location information written thereon.
3. The bearings and distances in degrees and feet between claim corners are as depicted on the above map.

When recorded return to:
Attn: Jon Bryant-Baker
BHP Mineral Resources Inc.
180 Magee Suite 134
Tucson, Arizona 85704

LOCATION NOTICE FOR LODE MINING CLAIM

NOTICE IS HEREBY GIVEN that the HOOK 52
_____ lode mining claim has been located
by BHP Mineral Resources Inc. whose current mailing
address is 180 Magee Suite 134
Tucson, Arizona 85704

RECEIVED
BHP MINERAL RESOURCES INC.
2020 APR 17 A 8:54
PHOENIX, ARIZONA

The general course of this claim is East/West and it is situated in Gila
County, Arizona. This claim is 1500 feet in length and 600 feet in width. This claim runs
from the location monument on which this location notice is posted approximately 10 feet in a
easterly direction to the east end line and 1490 feet in a westerly direction to the
west end line. This claim is marked by six monuments, one at each corner and one at the center of each
end line of the claim.

The location monument on which this notice is posted is situated within Section 35, Township 2
North, Range 15.5 East, Gila Salt River Base and Meridian, Arizona and this claim encompasses portions
of the following quarter section (s), section (s), Township (s) and Range (s) SW 1/4 of the NW 1/4 and NW 1/4
of the SW 1/4 of Section 35, and SE 1/4 of the NE 1/4 and NE 1/4 of the SE 1/4 of Section 34, Township 2
North, Range 15.5 East, Gila & Salt River Base and Meridian, Gila County, Arizona, Globe Mining District.

The locality of this claim with reference to some natural object or permanent monument and additional information
(if any) concerning its locality are as follows: 18977 feet north and 15906 feet east from the southwest corner of
Section 14, Township 1 North, Range 15 East, to the northeast corner of said claim.

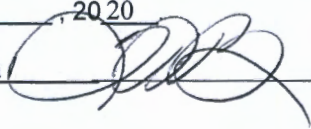
DATED AND POSTED on the ground this 26th day of February, 2020
LOCATOR (s) BHP Mineral Resources Inc. AGENT: T. Robert Breen 
180 Magee Suite 134
Tucson, Arizona 85704

AMC459829

LODE CLAIM LOCATION MAP

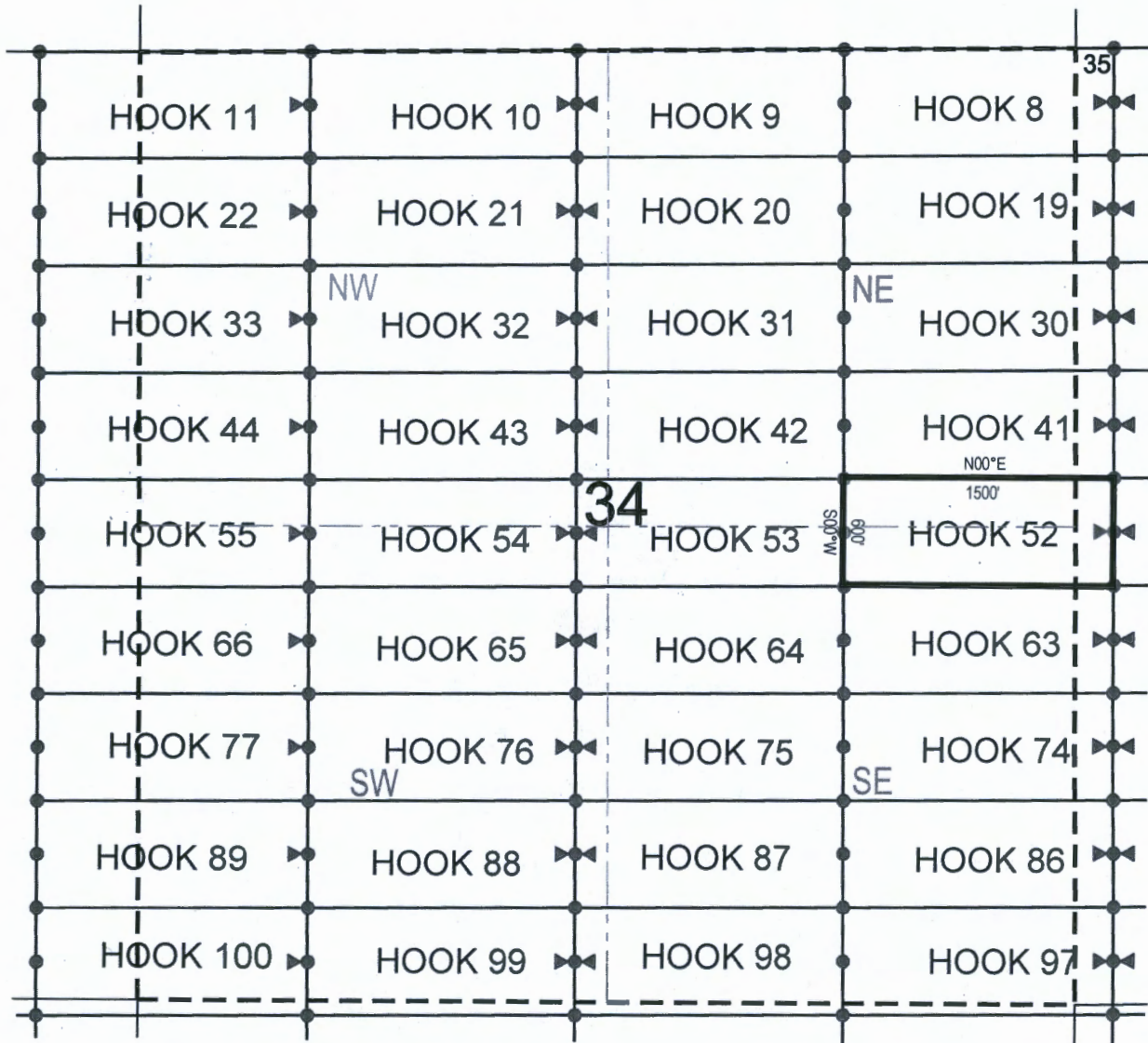

● Corner Posts ▲ Location Monuments Scale: 1"=1000'



1. The above map depicts the **HOOK 52** Lode Claim, which is located in the SW 1/4 of the NW 1/4 and NW 1/4 of the SW 1/4 of Section 35, and SE 1/4 of the NE 1/4 and NE 1/4 of the SE 1/4 of Section 34, Township 2 North, Range 15.5 East, Gila & Salt River Base and Meridian, Gila County, Arizona, Globe Mining District.
2. The type of corner and location monuments used are wood 2"x2"x48" posts and metal tags with location information written thereon.
3. The bearings and distances in degrees and feet between claim corners are as depicted on the above map.

When recorded return to:
Attn: Jon Bryant-Baker
BHP Mineral Resources Inc.
180 Magee Suite 134
Tucson, Arizona 85704

LOCATION NOTICE FOR LODE MINING CLAIM

NOTICE IS HEREBY GIVEN that the HOOK 62
_____ lode mining claim has been located
by BHP Mineral Resources Inc. whose current mailing
address is 180 Magee Suite 134
Tucson, Arizona 85704

RECEIVED
BLM #2 STATE OFFICE
2020 APR 17 A 8:51
PHOENIX, ARIZONA

The general course of this claim is East/West and it is situated in Gila
County, Arizona. This claim is 1500 feet in length and 600 feet in width. This claim runs
from the location monument on which this location notice is posted approximately 1490 feet in a
easterly direction to the east end line and 10 feet in a westerly direction to the
west end line. This claim is marked by six monuments, one at each corner and one at the center of each
end line of the claim.

The location monument on which this notice is posted is situated within Section 35, Township 2
North, Range 15.5 East, Gila Salt River Base and Meridian, Arizona and this claim encompasses portions
of the following quarter section (s), section (s), Township (s) and Range (s) NW 1/4 of the SW 1/4 and NE 1/4
of the SW 1/4 of Section 35, Township 2 North, Range 15.5 East, Gila & Salt River Base and Meridian, Gila
County, Arizona, Globe Mining District.

The locality of this claim with reference to some natural object or permanent monument and additional information
(if any) concerning its locality are as follows: 18386 feet north and 17409 feet east from the southwest corner of
Section 14, Township 1 North, Range 15 East, to the northeast corner of said claim.

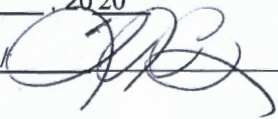
DATED AND POSTED on the ground this 26th day of February, 2020
LOCATOR (s) BHP Mineral Resources Inc. AGENT: T. Robert Breen 
180 Magee Suite 134
Tucson, Arizona 85704

AMC459830

LODE CLAIM LOCATION MAP

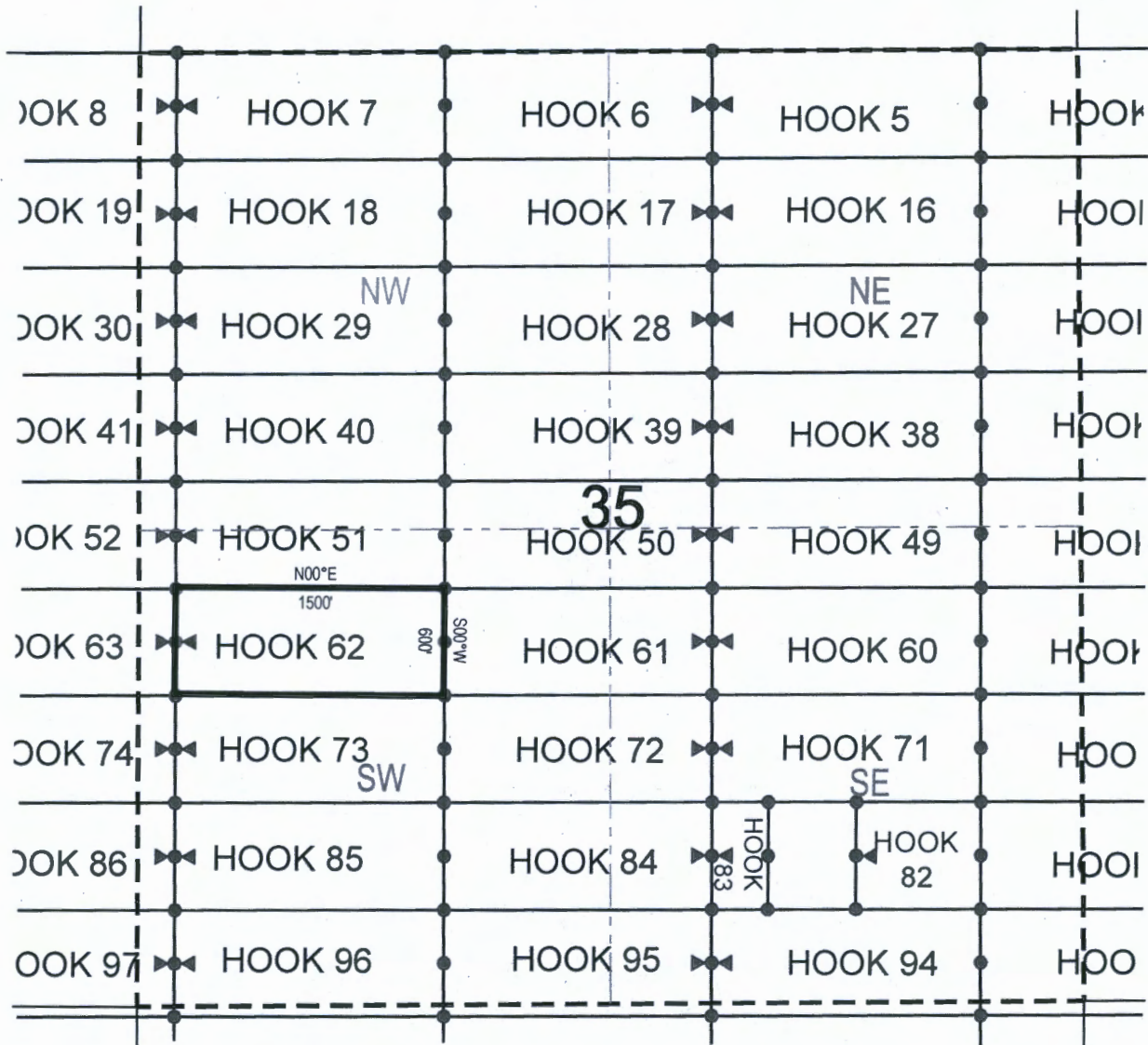

● Corner Posts ▲ Location Monuments Scale: 1"=1000'



1. The above map depicts the **HOOK 62** Lode Claim, which is located in the NW 1/4 of the SW 1/4 and NE 1/4 of the SW 1/4 of Section 35, Township 2 North, Range 15.5 East, Gila & Salt River Base and Meridian, Gila County, Arizona, Globe Mining District.
2. The type of corner and location monuments used are wood 2"x2"x48" posts and metal tags with location information written thereon.
3. The bearings and distances in degrees and feet between claim corners are as depicted on the above map.

When recorded return to:

Attn: Jon Bryant-Baker
BHP Mineral Resources Inc.
180 Magee Suite 134
Tucson, Arizona 85704

LOCATION NOTICE FOR LODE MINING CLAIM

NOTICE IS HEREBY GIVEN that the HOOK 63
_____ lode mining claim has been located
by BHP Mineral Resources Inc. whose current mailing
address is 180 Magee Suite 134
Tucson, Arizona 85704

RECEIVED
BLM-AZ STATE OFFICE
2020 APR 17 A 8:52
PHOENIX, ARIZONA

The general course of this claim is East/West and it is situated in Gila
County, Arizona. This claim is 1500 feet in length and 600 feet in width. This claim runs
from the location monument on which this location notice is posted approximately 10 feet in a
easterly direction to the east end line and 1490 feet in a westerly direction to the
west end line. This claim is marked by six monuments, one at each corner and one at the center of each
end line of the claim.

The location monument on which this notice is posted is situated within Section 35, Township 2
North, Range 15.5 East, Gila Salt River Base and Meridian, Arizona and this claim encompasses portions
of the following quarter section (s), section (s), Township (s) and Range (s) NW 1/4 of the SW 1/4 of Section
35, and NE 1/4 of the SE 1/4 of Section 34, Township 2 North, Range 15.5 East, Gila & Salt River Base and
Meridian, Gila County, Arizona, Globe Mining District.

The locality of this claim with reference to some natural object or permanent monument and additional information
(if any) concerning its locality are as follows: 18377 feet north and 15909 feet east from the southwest corner of
Section 14, Township 1 North, Range 15 East, to the northeast corner of said claim.

DATED AND POSTED on the ground this 26th day of February, 2020

LOCATOR (s) BHP Mineral Resources Inc. AGENT: T. Robert Breen
180 Magee Suite 134
Tucson, Arizona 85704

AR C 459831

LODE CLAIM LOCATION MAP

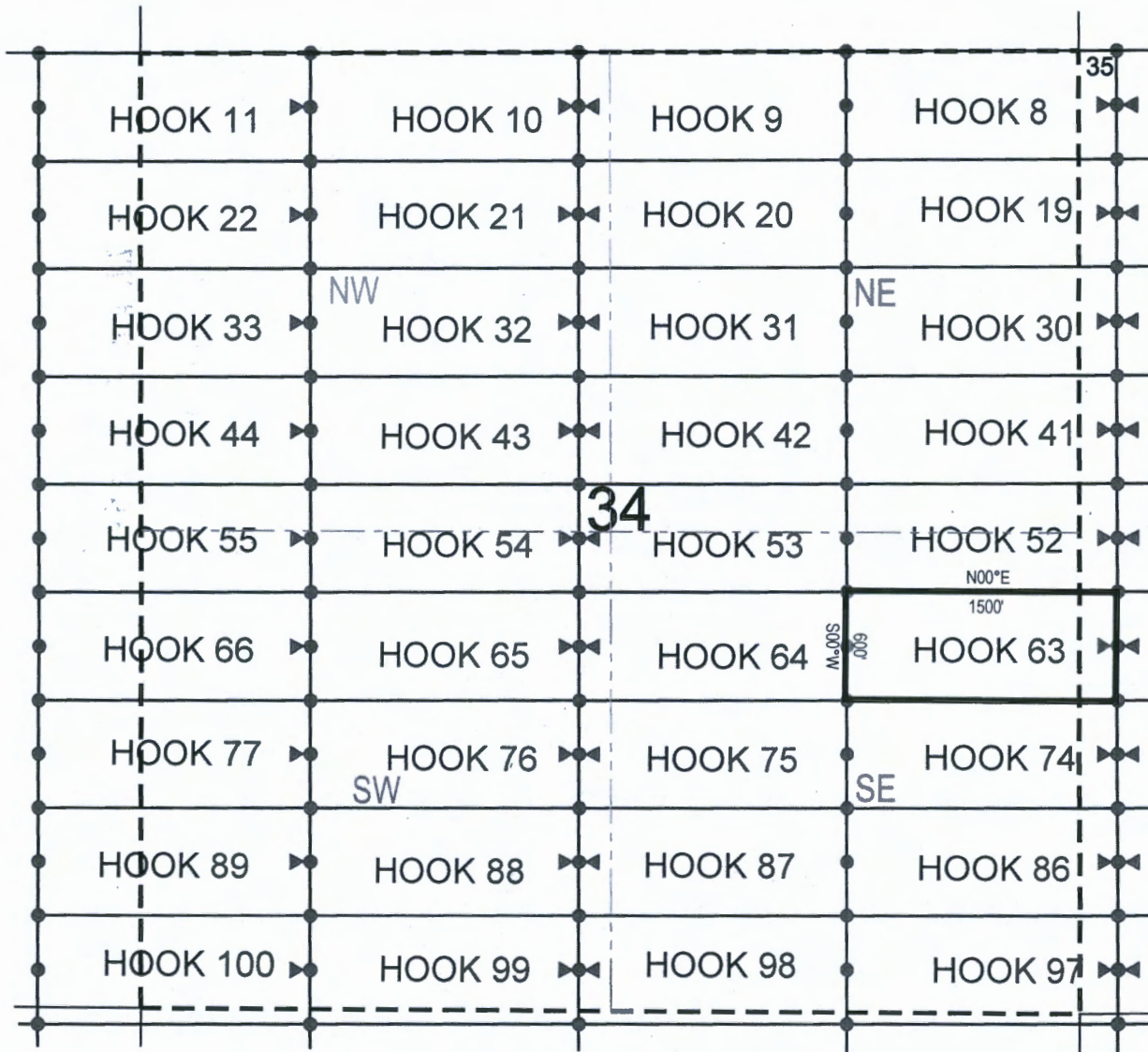

● Corner Posts ▲ Location Monuments Scale: 1"=1000'



1. The above map depicts the **HOOK 63** Lode Claim, which is located in the NW 1/4 of the SW 1/4 of Section 35, and NE 1/4 of the SE 1/4 of Section 34, Township 2 North, Range 15.5 East, Gila & Salt River Base and Meridian, Gila County, Arizona, Globe Mining District.
2. The type of corner and location monuments used are wood 2"x2"x48" posts and metal tags with location information written thereon.
3. The bearings and distances in degrees and feet between claim corners are as depicted on the above map.

When recorded return to:
Attn: Jon Bryant-Baker
BHP Mineral Resources Inc.
180 Magee Suite 134
Tucson, Arizona 85704

LOCATION NOTICE FOR LODE MINING CLAIM

NOTICE IS HEREBY GIVEN that the HOOK 73
_____ lode mining claim has been located
by BHP Mineral Resources Inc. whose current mailing
address is 180 Magee Suite 134
Tucson, Arizona 85704

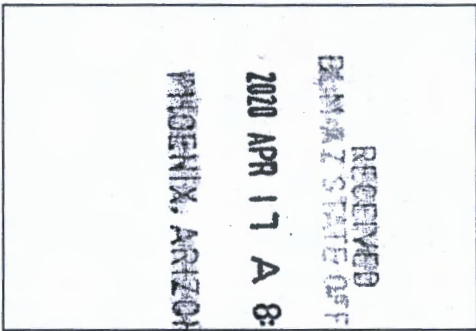

The general course of this claim is East/West and it is situated in Gila
County, Arizona. This claim is 1500 feet in length and 600 feet in width. This claim runs
from the location monument on which this location notice is posted approximately 1490 feet in a
easterly direction to the east end line and 10 feet in a westerly direction to the
west end line. This claim is marked by six monuments, one at each corner and one at the center of each
end line of the claim.

The location monument on which this notice is posted is situated within Section 35, Township 2
North, Range 15.5 East, Gila Salt River Base and Meridian, Arizona and this claim encompasses portions
of the following quarter section (s), section (s), Township (s) and Range (s) NW 1/4 of the SW 1/4, SW 1/4 of
the SW 1/4, SE 1/4 of the SW 1/4 and NE 1/4 of the SW 1/4 of Section 35, Township 2 North, Range 15.5
East, Gila & Salt River Base and Meridian, Gila County, Arizona, Globe Mining District.

The locality of this claim with reference to some natural object or permanent monument and additional information
(if any) concerning its locality are as follows: 17786 feet north and 17413 feet east from the southwest corner of
Section 14, Township 1 North, Range 15 East, to the northeast corner of said claim.

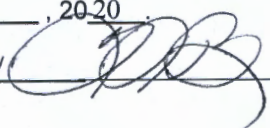
DATED AND POSTED on the ground this 26th day of February, 2020
LOCATOR (s) BHP Mineral Resources Inc. AGENT: T. Robert Breen / 
180 Magee Suite 134
Tucson, Arizona 85704

AMC459832

LODE CLAIM LOCATION MAP

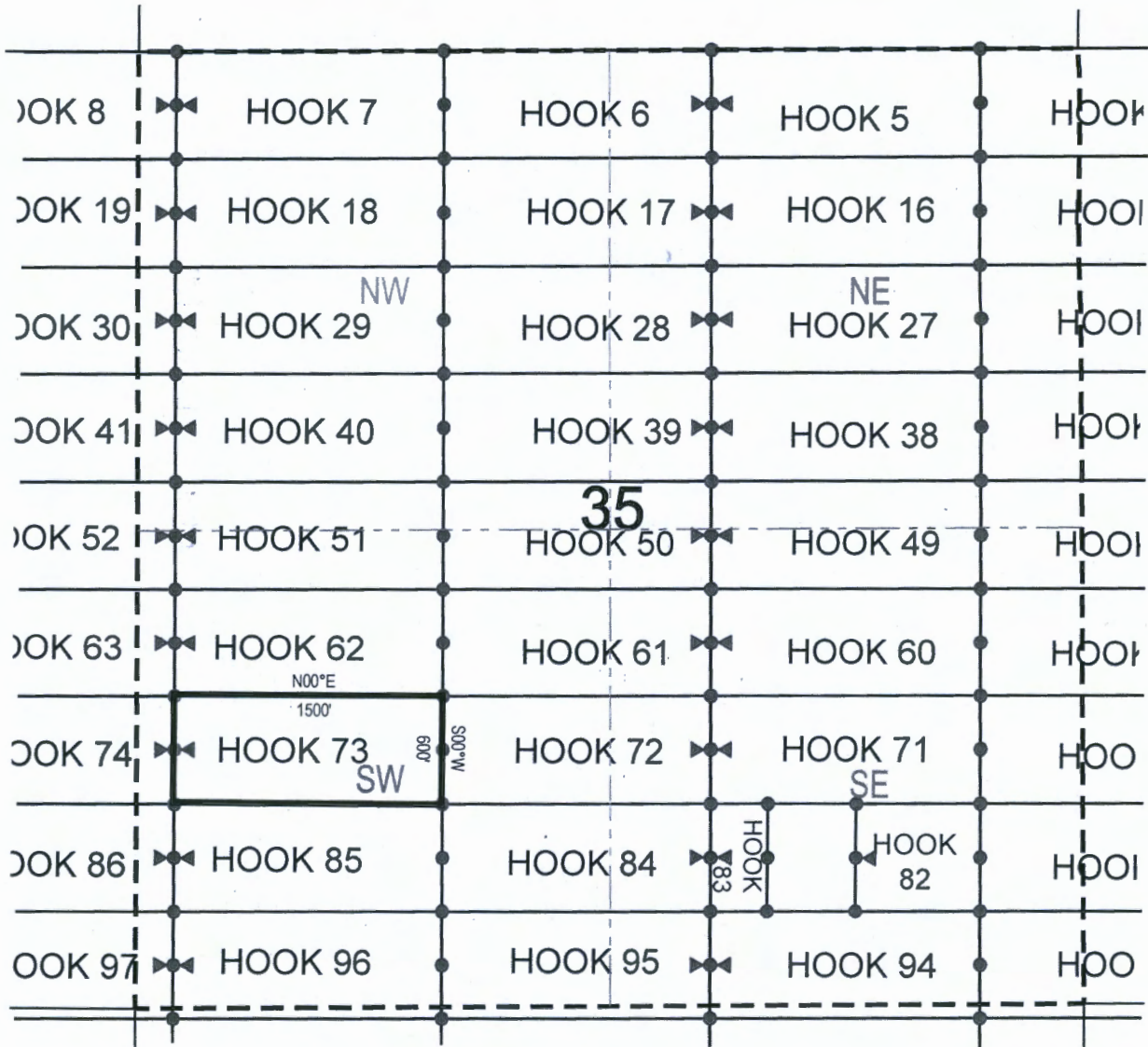

● Corner Posts ▲ Location Monuments Scale: 1"=1000'



1. The above map depicts the **HOOK 73** Lode Claim, which is located in the NW 1/4 of the SW 1/4, SW 1/4 of the SW 1/4, SE 1/4 of the SW 1/4 and NE 1/4 of the SW 1/4 of Section 35, Township 2 North, Range 15.5 East, Gila & Salt River Base and Meridian, Gila County, Arizona, Globe Mining District.
2. The type of corner and location monuments used are wood 2"x2"x48" posts and metal tags with location information written thereon.
3. The bearings and distances in degrees and feet between claim corners are as depicted on the above map.

When recorded return to:

Attn: Jon Bryant-Baker
BHP Mineral Resources Inc.
180 Magee Suite 134
Tucson, Arizona 85704

LOCATION NOTICE FOR LODE MINING CLAIM

NOTICE IS HEREBY GIVEN that the HOOK 74
_____ lode mining claim has been located
by BHP Mineral Resources Inc. whose current mailing
address is 180 Magee Suite 134
Tucson, Arizona 85704

RECEIVED
BLM #7 STATE OFFICE
2020 APR 17 A 8:55
PHOENIX, ARIZONA

The general course of this claim is East/West and it is situated in Gila
County, Arizona. This claim is 1500 feet in length and 600 feet in width. This claim runs
from the location monument on which this location notice is posted approximately 10 feet in a
easterly direction to the east end line and 1490 feet in a westerly direction to the
west end line. This claim is marked by six monuments, one at each corner and one at the center of each
end line of the claim.

The location monument on which this notice is posted is situated within Section 35, Township 2
North, Range 15.5 East, Gila Salt River Base and Meridian, Arizona and this claim encompasses portions
of the following quarter section (s), section (s), Township (s) and Range (s) NW 1/4 of the SW 1/4 and SW 1/4
of the SW 1/4 of Section 35, and NE 1/4 of the SE 1/4 and SE 1/4 of the SE 1/4 of Section 34, Township 2
North, Range 15.5 East, Gila & Salt River Base and Meridian, Gila County, Arizona, Globe Mining District.

The locality of this claim with reference to some natural object or permanent monument and additional information
(if any) concerning its locality are as follows: 17777 feet north and 15913 feet east from the southwest corner of
Section 14, Township 1 North, Range 15 East, to the northeast corner of said claim.

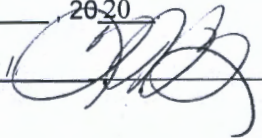
DATED AND POSTED on the ground this 26th day of February 2020
LOCATOR (s) BHP Mineral Resources Inc. AGENT: T. Robert Breen 
180 Magee Suite 134
Tucson, Arizona 85704

AMC 459833

LODE CLAIM LOCATION MAP

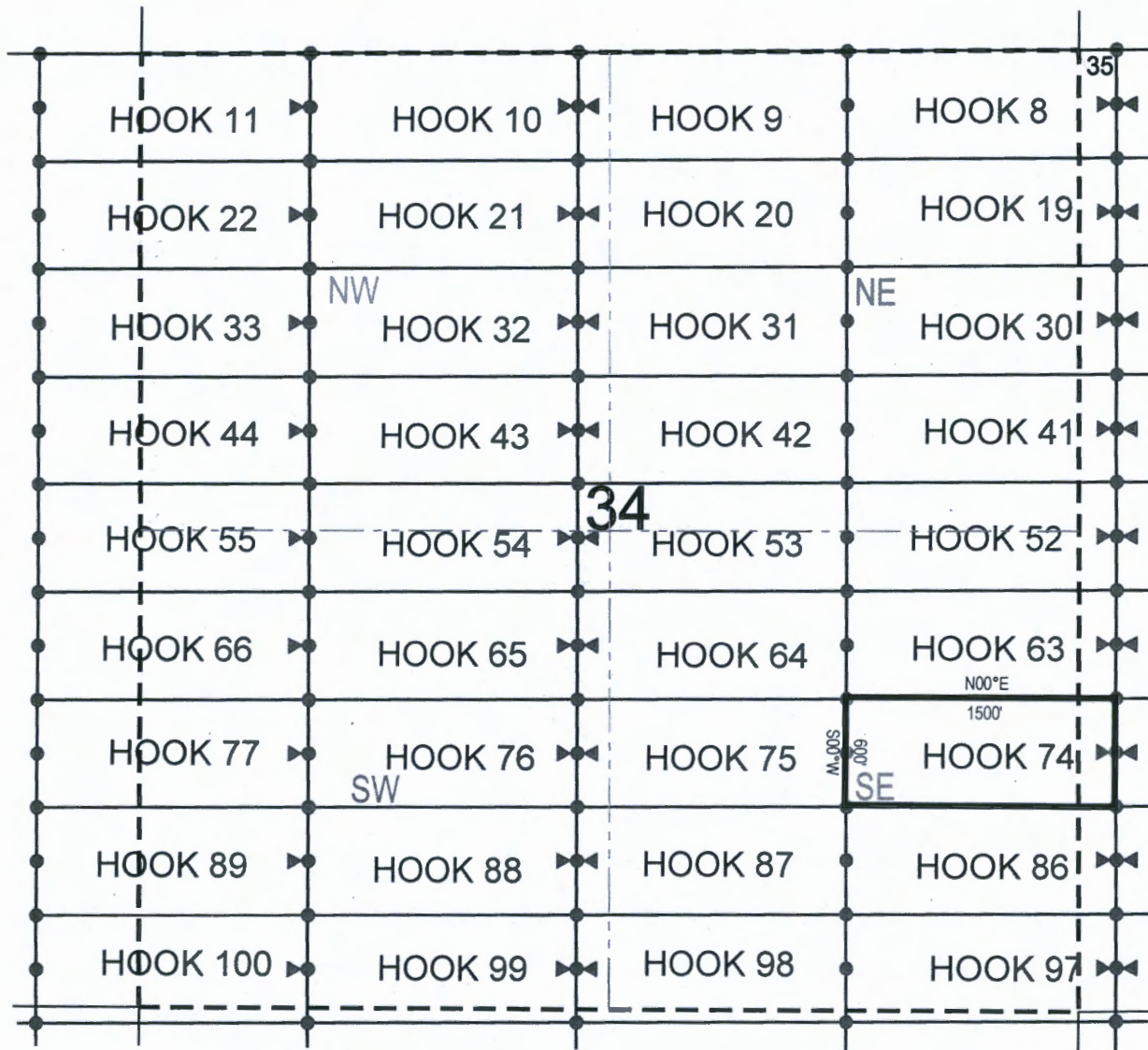

● Corner Posts ▲ Location Monuments Scale: 1"=1000'



1. The above map depicts the **HOOK 74** Lode Claim, which is located in the NW 1/4 of the SW 1/4 and SW 1/4 of the SW 1/4 of Section 35, and NE 1/4 of the SE 1/4 and SE 1/4 of the SE 1/4 of Section 34, Township 2 North, Range 15.5 East, Gila & Salt River Base and Meridian, Gila County, Arizona, Globe Mining District.
2. The type of corner and location monuments used are wood 2"x2"x48" posts and metal tags with location information written thereon.
3. The bearings and distances in degrees and feet between claim corners are as depicted on the above map.

When recorded return to:

Attn: Jon Bryant-Baker
BHP Mineral Resources Inc.
180 Magee Suite 134
Tucson, Arizona 85704

LOCATION NOTICE FOR LODE MINING CLAIM

NOTICE IS HEREBY GIVEN that the HOOK 85
_____ lode mining claim has been located
by BHP Mineral Resources Inc. whose current mailing
address is 180 Magee Suite 134
Tucson, Arizona 85704

RECEIVED
BHP MINERAL RESOURCES INC.
2020 APR 17 A 8:55
PHOENIX, ARIZONA

The general course of this claim is East/West and it is situated in Gila
County, Arizona. This claim is 1500 feet in length and 600 feet in width. This claim runs
from the location monument on which this location notice is posted approximately 1490 feet in a
easterly direction to the east end line and 10 feet in a westerly direction to the
west end line. This claim is marked by six monuments, one at each corner and one at the center of each
end line of the claim.

The location monument on which this notice is posted is situated within Section 35, Township 2
North, Range 15.5 East, Gila Salt River Base and Meridian, Arizona and this claim encompasses portions
of the following quarter section (s), section (s), Township (s) and Range (s) SW 1/4 of the SW 1/4 and SE 1/4
of the SW 1/4 of Section 35, Township 2 North, Range 15.5 East, Gila & Salt River Base and Meridian, Gila
County, Arizona, Globe Mining District.

The locality of this claim with reference to some natural object or permanent monument and additional information
(if any) concerning its locality are as follows: 17186 feet north and 17416 feet east from the southwest corner of
Section 14, Township 1 North, Range 15 East, to the northeast corner of said claim.

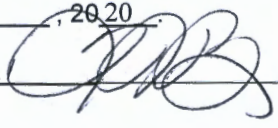
DATED AND POSTED on the ground this 26th day of February, 2020
LOCATOR (s) BHP Mineral Resources Inc. AGENT: T. Robert Breen 
180 Magee Suite 134
Tucson, Arizona 85704

AMC459834

LODE CLAIM LOCATION MAP

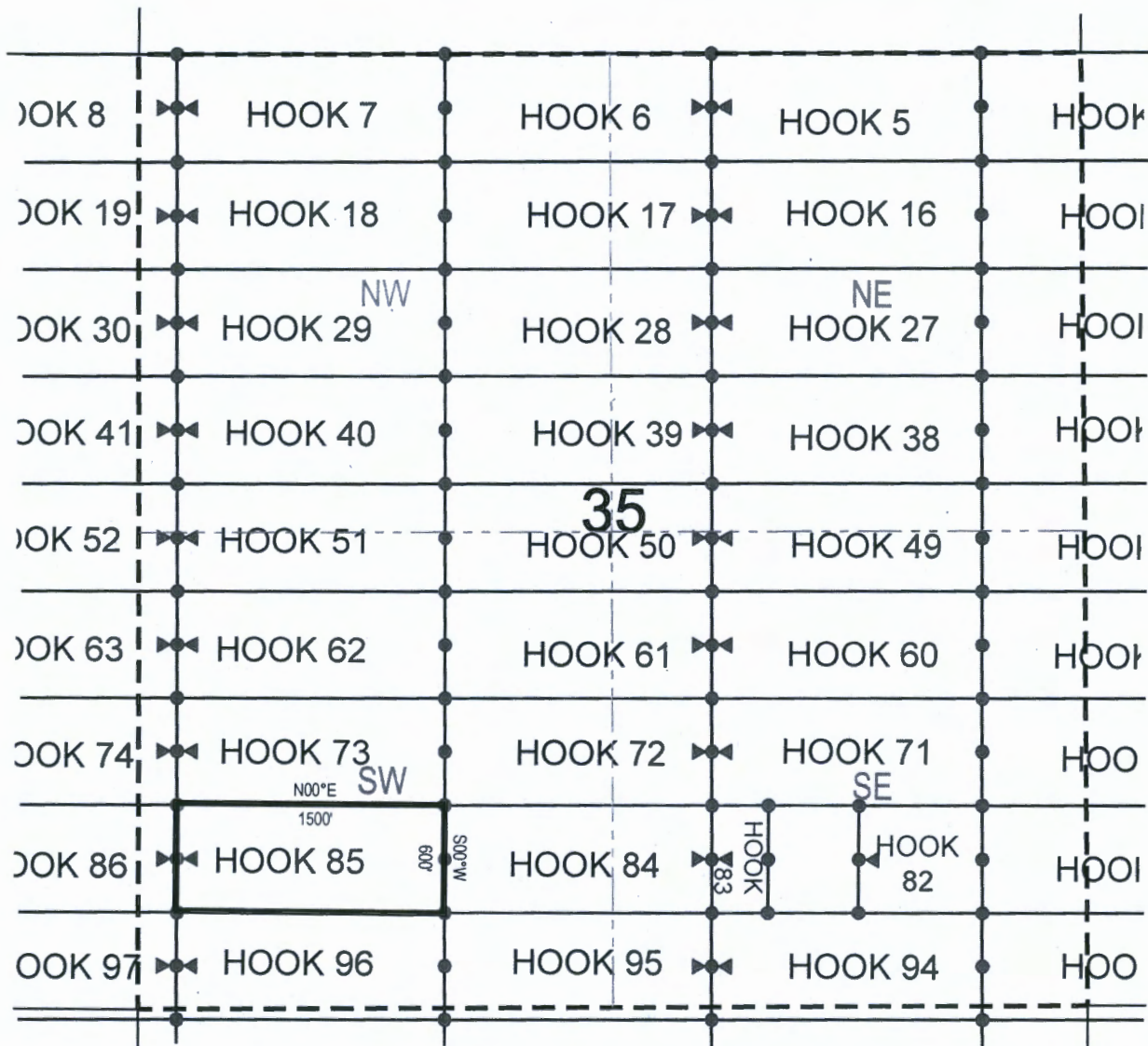

● Corner Posts ▲ Location Monuments Scale: 1"=1000'



1. The above map depicts the **HOOK 85** Lode Claim, which is located in the SW 1/4 of the SW 1/4 and SE 1/4 of the SW 1/4 of Section 35, Township 2 North, Range 15.5 East, Gila & Salt River Base and Meridian, Gila County, Arizona, Globe Mining District.
2. The type of corner and location monuments used are wood 2"x2"x48" posts and metal tags with location information written thereon.
3. The bearings and distances in degrees and feet between claim corners are as depicted on the above map.

When recorded return to:

Attn: Jon Bryant-Baker
BHP Mineral Resources Inc.
180 Magee Suite 134
Tucson, Arizona 85704

LOCATION NOTICE FOR LODE MINING CLAIM

NOTICE IS HEREBY GIVEN that the HOOK 86
_____ lode mining claim has been located
by BHP Mineral Resources Inc. whose current mailing
address is 180 Magee Suite 134
Tucson, Arizona 85704

RECEIVED
BUREAU OF STATE OFFICE
2020 APR 17 A 8:55
PHOENIX, ARIZONA

The general course of this claim is East/West and it is situated in Gila
County, Arizona. This claim is 1500 feet in length and 600 feet in width. This claim runs
from the location monument on which this location notice is posted approximately 10 feet in a
easterly direction to the east end line and 1490 feet in a westerly direction to the
west end line. This claim is marked by six monuments, one at each corner and one at the center of each
end line of the claim.

The location monument on which this notice is posted is situated within Section 35, Township 2
North, Range 15.5 East, Gila Salt River Base and Meridian, Arizona and this claim encompasses portions
of the following quarter section (s), section (s), Township (s) and Range (s) SW 1/4 of the SW 1/4 of Section
35, and SE 1/4 of the SE 1/4 of Section 34, Township 2 North, Range 15.5 East, Gila & Salt River Base and
Meridian, Gila County, Arizona, Globe Mining District.

The locality of this claim with reference to some natural object or permanent monument and additional information
(if any) concerning its locality are as follows: 17177 feet north and 15916 feet east from the southwest corner of
Section 14, Township 1 North, Range 15 East, to the northeast corner of said claim.

DATED AND POSTED on the ground this 26th day of February, 2020

LOCATOR (s) BHP Mineral Resources Inc. AGENT: T. Robert Breen 
180 Magee Suite 134
Tucson, Arizona 85704

ANCI 459835

LODE CLAIM LOCATION MAP

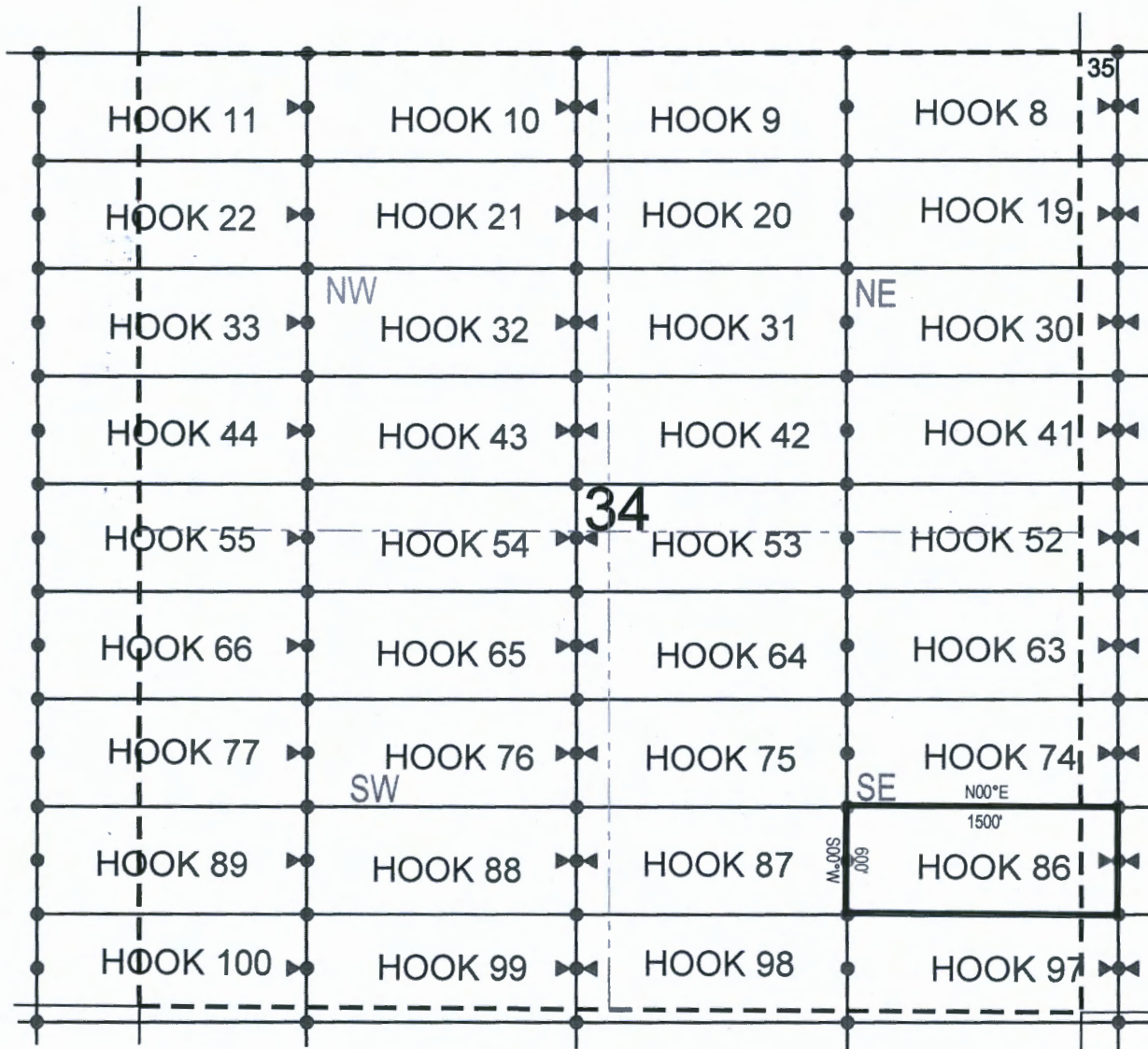

● Corner Posts ▲ Location Monuments Scale: 1"=1000'



1. The above map depicts the **HOOK 86** Lode Claim, which is located in the SW 1/4 of the SW 1/4 of Section 35, and SE 1/4 of the SE 1/4 of Section 34, Township 2 North, Range 15.5 East, Gila & Salt River Base and Meridian, Gila County, Arizona, Globe Mining District.
2. The type of corner and location monuments used are wood 2"x2"x48" posts and metal tags with location information written thereon.
3. The bearings and distances in degrees and feet between claim corners are as depicted on the above map.

When recorded return to:
Attn: Jon Bryant-Baker
BHP Mineral Resources Inc.
180 Magee Suite 134
Tucson, Arizona 85704

LOCATION NOTICE FOR LODE MINING CLAIM

NOTICE IS HEREBY GIVEN that the HOOK 96
_____ lode mining claim has been located
by BHP Mineral Resources Inc. whose current mailing
address is 180 Magee Suite 134
Tucson, Arizona 85704

RECEIVED
BLM AT STATE OFFICE
2020 APR 17 A 8:55
PHOENIX, ARIZONA

The general course of this claim is East/West and it is situated in Gila
County, Arizona. This claim is 1500 feet in length and 600 feet in width. This claim runs
from the location monument on which this location notice is posted approximately 1490 feet in a
easterly direction to the east end line and 10 feet in a westerly direction to the
west end line. This claim is marked by six monuments, one at each corner and one at the center of each
end line of the claim.

The location monument on which this notice is posted is situated within Section 35, Township 2
North, Range 15.5 East, Gila Salt River Base and Meridian, Arizona and this claim encompasses portions
of the following quarter section (s), section (s), Township (s) and Range (s) SW 1/4 of the SW 1/4 and SE 1/4
of the SW 1/4 of Section 35, Township 2 North, Range 15.5 East, and NW 1/4 of the NW 1/4 and NE 1/4 of
the NW 1/4 of Section 2, Township 1 North, Range 15.5 East, Gila & Salt River Base and Meridian, Gila
County, Arizona, Globe Mining District.

The locality of this claim with reference to some natural object or permanent monument and additional information
(if any) concerning its locality are as follows: 16586 feet north and 17420 feet east from the southwest corner of
Section 14, Township 1 North, Range 15 East, to the northeast corner of said claim.

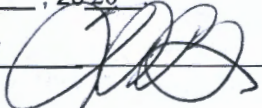
DATED AND POSTED on the ground this 26th day of February, 2020
LOCATOR (s) BHP Mineral Resources Inc. AGENT: T. Robert Breen / 
180 Magee Suite 134
Tucson, Arizona 85704

AMC459836

LODE CLAIM LOCATION MAP

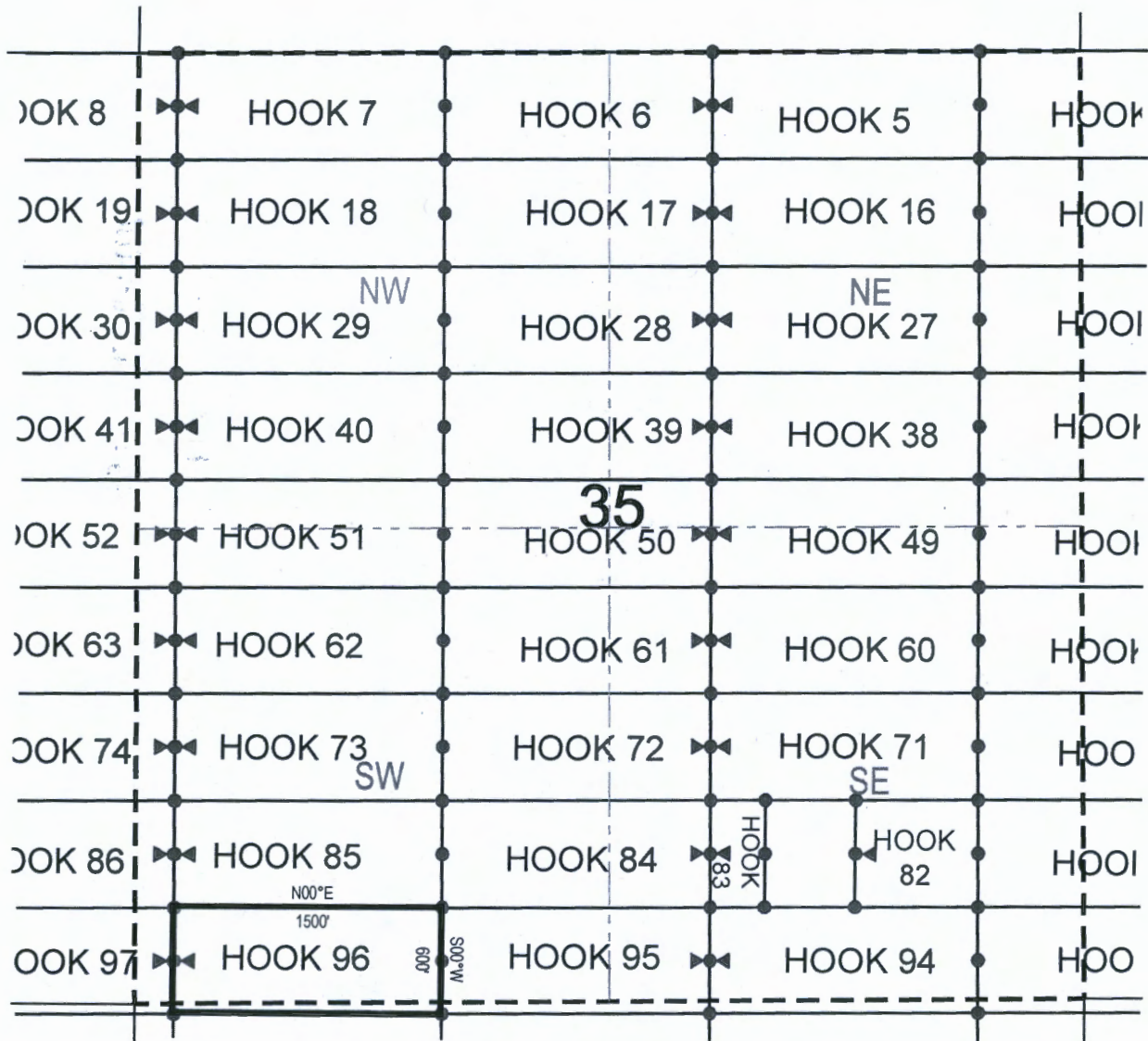

● Corner Posts ▲ Location Monuments Scale: 1"=1000'



1. The above map depicts the **HOOK 96** Lode Claim, which is located in the SW 1/4 of the SW 1/4 and SE 1/4 of the SW 1/4 of Section 35, Township 2 North, Range 15.5 East, and NW 1/4 of the NW 1/4 and NE 1/4 of the NW 1/4 of Section 2, Township 1 North, Range 15.5 East, Gila & Salt River Base and Meridian, Gila County, Arizona, Globe Mining District.
2. The type of corner and location monuments used are wood 2"x2"x48" posts and metal tags with location information written thereon.
3. The bearings and distances in degrees and feet between claim corners are as depicted on the above map.

When recorded return to:

Attn: Jon Bryant-Baker
BHP Mineral Resources Inc.
180 Magee Suite 134
Tucson, Arizona 85704

LOCATION NOTICE FOR LODE MINING CLAIM

NOTICE IS HEREBY GIVEN that the HOOK 97
_____ lode mining claim has been located
by BHP Mineral Resources Inc. whose current mailing
address is 180 Magee Suite 134
Tucson, Arizona 85704

RECEIVED
DEPT. OF STATE OFFICE
2020 APR 17 A 8:55
PHOENIX, ARIZONA

The general course of this claim is East/West and it is situated in Gila
County, Arizona. This claim is 1500 feet in length and 600 feet in width. This claim runs
from the location monument on which this location notice is posted approximately 10 feet in a
easterly direction to the east end line and 1490 feet in a westerly direction to the
west end line. This claim is marked by six monuments, one at each corner and one at the center of each
end line of the claim.

The location monument on which this notice is posted is situated within Section 35, Township 2
North, Range 15.5 East, Gila Salt River Base and Meridian, Arizona and this claim encompasses portions
of the following quarter section (s), section (s), Township (s) and Range (s) SW 1/4 of the SW 1/4 of Section
35, and SE 1/4 of the SE 1/4 of Section 34, Township 2 North, Range 15.5 East, and NE 1/4 of the NE 1/4 of
Section 3, and NW 1/4 of the NW 1/4 of Section 2, Township 1 North, Range 15.5 East, Gila & Salt River
Base and Meridian, Gila County, Arizona, Globe Mining District.

The locality of this claim with reference to some natural object or permanent monument and additional information
(if any) concerning its locality are as follows: 16577 feet north and 15920 feet east from the southwest corner of
Section 14, Township 1 North, Range 15 East, to the northeast corner of said claim.

DATED AND POSTED on the ground this 26th day of February, 2020

LOCATOR (s) BHP Mineral Resources Inc. AGENT: T. Robert Breen / 
180 Magee Suite 134
Tucson, Arizona 85704

AMC459837

LODE CLAIM LOCATION MAP

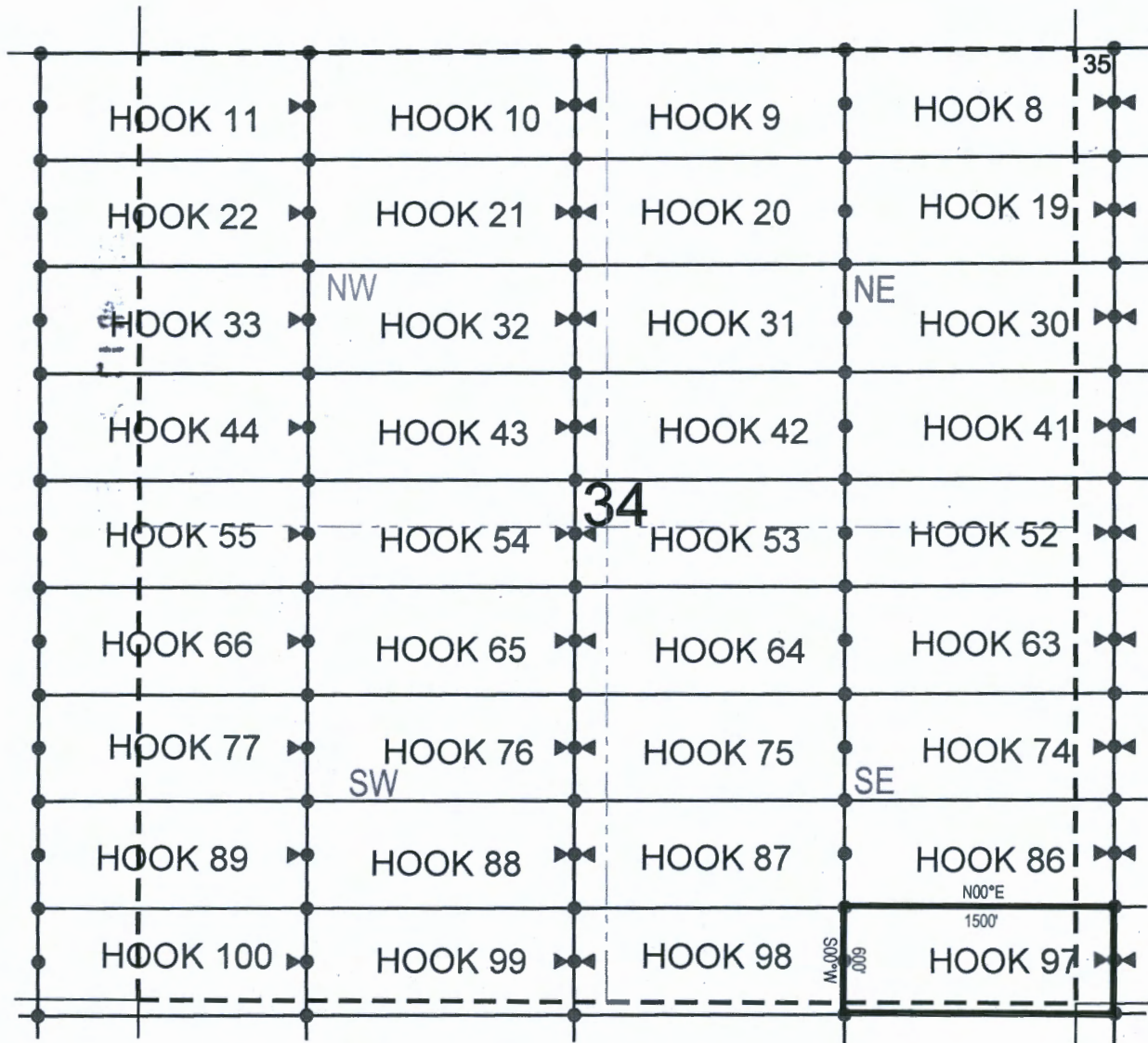

● Corner Posts ▲ Location Monuments Scale: 1"=1000'



1. The above map depicts the **HOOK 97** Lode Claim, which is located in the SW 1/4 of the SW 1/4 of Section 35, and SE 1/4 of the SE 1/4 of Section 34, Township 2 North, Range 15.5 East, and NE 1/4 of the NE 1/4 of Section 3, and NW 1/4 of the NW 1/4 of Section 2, Township 1 North, Range 15.5 East, Gila & Salt River Base and Meridian, Gila County, Arizona, Globe Mining District.
2. The type of corner and location monuments used are wood 2"x2"x48" posts and metal tags with location information written thereon.
3. The bearings and distances in degrees and feet between claim corners are as depicted on the above map.

1117



LR2000 Internal

CR Geographic Report with Land

Download User Guide (pdf)

Purpose: This report produces a geographic listing of case information based on retrieval by Meridian/Township/Range. This report format will display the case type, case disposition, meridian, township, range, section, survey type, survey number, surface management agency, pending actions, serial number, and total case acres.

To refresh the query, do a **Ctrl-R**. It resets the page and clears any criteria fields that may have entries.



No Results

The specified criteria didn't result in any data. This is often caused by applying filters and/or selection steps that are too restrictive or that contain incorrect values. Please check your analysis filters and selection steps, and try again. The filters or selection steps currently being applied are shown below.

Filters

Disposition is equal to **AUTHORIZED, CANCELLED, EXPIRED, PENDING, REJECTED, RELINQUISHED, WITHDRAWN**
and Meridian Township Range Section is equal to **14 0020N 0152E 034, 14 0020N 0152E 035, 14 0010N 0152E 002, 14 0010N 0152E 003**
and Admin State is equal to **AZ**

UNSURVEYED TOWNSHIP 2 NORTH RANGE 15½ EAST OF THE GILA AND SALT RIVER MERIDIAN, ARIZONA

AMENDED PROTRACTION DIAGRAM OFFICIALLY FILED 11/26/2013

GILA COUNTY
SAFFORD FIELD OFFICE

STATUS OF PUBLIC DOMAIN
LAND AND MINERAL TITLES

INDEX TO SEGREGATED TRACTS				
RESURVEY TRACT NO.	ORIGINAL SURVEY			
	T	R	SEC	SUBDIVISION

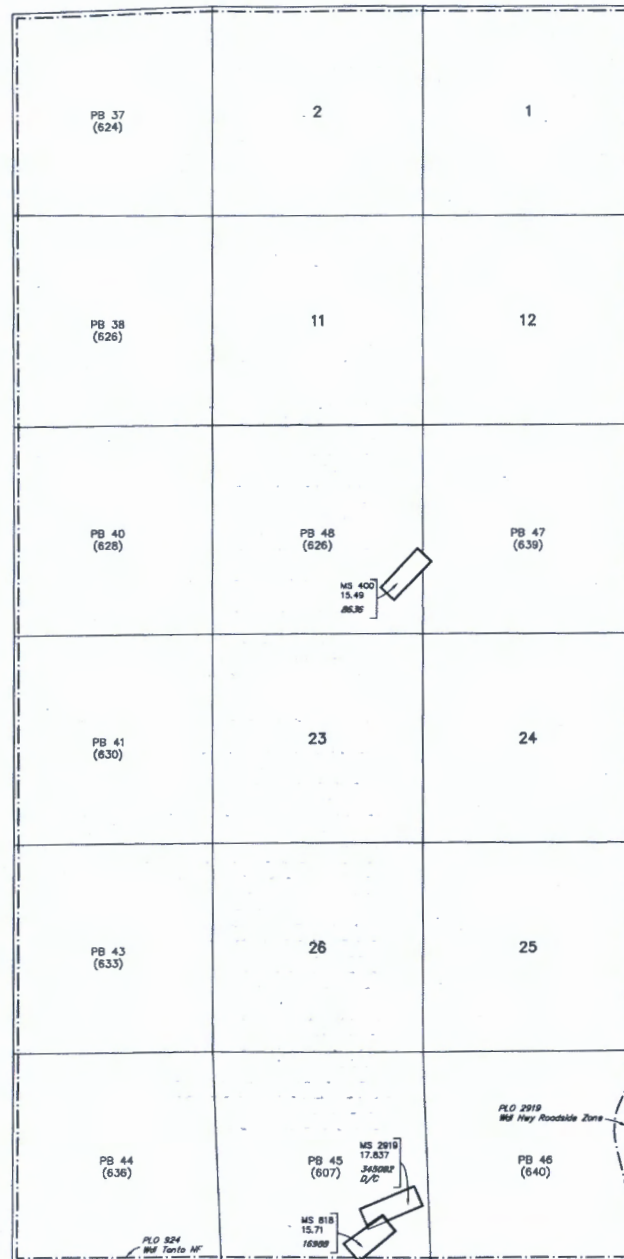

FOR ORDERS AFFECTING DISPOSAL OR USE OF UNIDENTIFIED LANDS WITHDRAWN FOR CLASSIFICATION, MINERALS, WATER AND/OR OTHER PUBLIC PURPOSES, REFER TO INDEX OF MISCELLANEOUS DOCUMENTS.

MDS 173 N1/2
174 S1/2

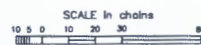

WARNING STATEMENT
This plot is the Bureau's Record of Title, and should be used only as a graphic display of the township survey data. Records herein do not reflect title changes which may have been effected by lateral movements of rivers or other bodies of water. Refer to the cadastral surveys for official survey information.

CURRENT TO	NW	GSR Mer
4-23-2019	ACAD	T 2 N
		R 15½ E

Insert shipping document here

ORIGIN ID:TUSA (520) 448-5891
JON BRYANT-BAKER
180 W MAGEE ROAD
SUITE 134
ORO VALLEY, AZ 85704
UNITED STATES US

SHIP DATE: 14APR20
ACTWGT: 2.00 LB
CAD: 110545296/INET4220

BILL SENDER

TO PUBLIC ROOM
BLM PUBLIC ROOM
1 N. CENTRAL AVE
SUITE 800
PHOENIX AZ 85004

(602) 417-9200
NY: PO:

REF:

DEPT:

568W/763AFEA

FedEx Ship Manager - Print Your Label(s)

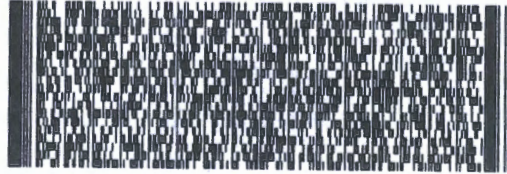

Extremely Urgent

WED - 15 APR 10:30A
PRIORITY OVERNIGHT

TRK# 7702 3385 6453
0201

98 ZSYA

85004
AZ-US PHX

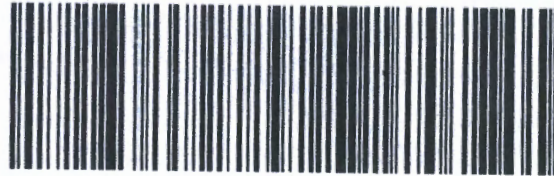

Express



4/14/2020





Envelope

Align top of FedEx Express® shipping label here.

RECEIVED
BLM AZ STATE OFFICE
PHOENIX, ARIZONA
17 APR 2020 8:55 A